

ROTOTILLER*

POWER TILLER

PARTS BOOK

MODELS

B1-6, B1-6RS, B1-7, B1-7RS, B1-7A, B1-7RA

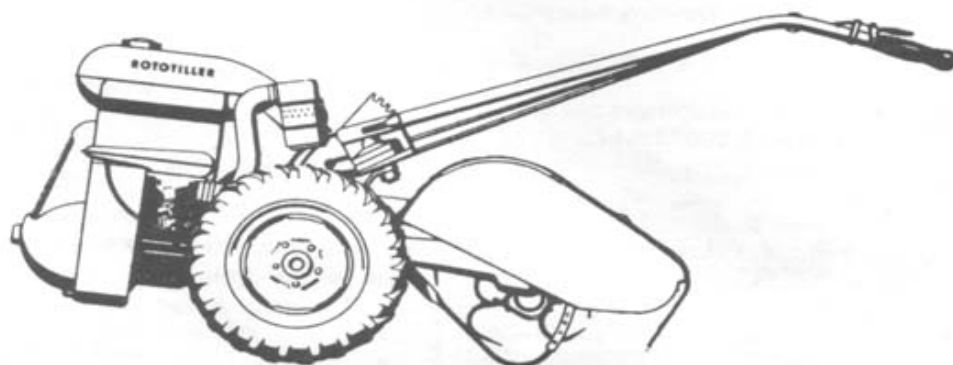

**FRAZER FARM EQUIPMENT CO.
AUBURN, INDIANA**

PRINTED
IN
U.S.A.

* "Registered Trademark-Duro Corporation, Oak Park, Michigan"

TO OUR ROTOTILLER CUSTOMERS

MODELS

B1-6—B1-6RS—B1-7—B1-7RS—B1-7A—B1-7RA

This Parts Book has been carefully compiled to cover all Models of the Rototiller manufactured by Frazer Farm Equipment Corporation. To assist you in properly identifying the parts you wish, the parts are listed in group sequence with exploded illustrations of the major assemblies. The major assemblies are listed first and all sub-assemblies or relating parts follow. An example of a typical breakdown is shown:—

GROUP 1.—ENGINE

- Group 1.000—Engine (less accessories)
- Group 1.100—Cylinder Block and related parts
- Group 1.200—Cylinder Head and related parts

GROUP 2.—ENGINE LUBRICATION

- Group 2.100—Crankcase and related parts

GROUP 3.—FUEL SYSTEM

- Group 3.000—Intake Manifold and related parts
- Group 3.200—Carburetor and related parts
- Group 3.210—Carburetor Main Body and related parts

Keep this illustrated Parts Book handy and refer to it when ordering repair parts. In the event you cannot obtain them locally, order direct from the factory.

GENERAL INFORMATION

GROUP INDEX

1—ENGINE

- 1.000—Engine (Less Accessories)
- 1.100—Cylinder Block
- 1.200—Cylinder Head
- 1.300—Crankshaft
- 1.400—Connecting Rod
- 1.410—Piston

2—ENGINE LUBRICATION

- 2.100—Crankcase

3—FUEL SYSTEM

- 3.000—Intake Manifold
- 3.200—Carburetor
- 3.210—Carburetor Main Body
- 3.220—Carburetor Choke Valve
- 3.230—Carburetor Choke Control Bracket
- 3.240—Carburetor Float, Needle Valve and Seat Assembly
- 3.250—Carburetor Main Discharge Needle
- 3.260—Carburetor Idle Tube and Nozzle
- 3.270—Carburetor Throttle Body
- 3.280—Carburetor Throttle Valve and Lever
- 3.285—Carburetor Throttle Control Bracket
- 3.290—Carburetor Repair Kits
- 3.330—Throttle Control
- 3.550—Fuel Strainer
- 3.600—Fuel Tank

4—AIR INTAKE SYSTEM

- 4.000—Air Cleaner

5—EXHAUST SYSTEM

- 5.000—Exhaust Manifold
- 5.040—Exhaust Muffler

6—ENGINE COOLING

- 6.000—Cooling Fan
- 6.010—Cooling Fan Housing

7—ELECTRICAL

- 7.000—Magneto
- 7.002—Magneto Housing Washer
- 7.005—Magneto Covers
- 7.010—Magneto Contact Point Set
- 7.015—Magneto Contact Breaker Cam
- 7.020—Magneto Condenser
- 7.025—Magneto Rotor
- 7.035—Magneto Rotor Front Plate
- 7.040—Magneto Ground Switch
- 7.045—Magneto Field Coil
- 7.050—Magneto Adjustable Coupling
- 7.065—Magneto Impulse Starter Drive Member
- 7.105—Magneto Impulse Starter Housing
- 7.115—Magneto Mounting Plate
- 7.120—Magneto Drive
- 7.140—Ignition Cable and Spark Plug
- 7.200—Starter (Manual)
- 7.205—Starter Cable Jaw Sheave
- 7.210—Starter Cable
- 7.220—Starting Dog

8—CLUTCH

- 8.000—Tiller Clutch Dog
- 8.005—Tiller Clutch Shock Absorber
- 8.010—Tiller Clutch Control Fork
- 8.015—Tiller Clutch Control Shaft
- 8.020—Tiller Clutch Control Rod
- 8.025—Tiller Clutch Shift Lever Lock Spring

9—TRANSMISSION

- 9.000—Transmission
- 9.005—Transmission Case
- 9.010—Transmission Drive Gear
- 9.020—Transmission Worm Gear
- 9.030—Transmission Gears (High and Low Speed)
- 9.040—Transmission Gears (High Speed)
- 9.050—Transmission Shift Mechanism
- 9.065—Transmission Shift Lever
- 9.070—Transmission Shift Control Rod
- 9.075—Transmission Shift Lever Lock Spring
- 9.080—Transmission Axle
- 9.085—Wheel Hub (Inner)
- 9.500—Reverse Gear Case
- 9.510—Reverse Gear Drive Pinion
- 9.520—Reverse Gear Idler Gear
- 9.530—Reverse Gear Worm Drive Gear and Shaft
- 9.545—Reverse Gear Shifter Fork and Lever
- 9.550—Stop Assembly—Reverse Shifter
- 9.555—Transmission Speed Shifter Arm and Link—Reverse Control
- 9.560—Transmission Speed Shifter Arm and Link
- 9.575—Magneto Drive Shaft and Gear
- 9.580—Miscellaneous Parts

10—TILLER AND DRIVE

- 10.000—Tiller Drive
- 10.005—Tiller Drive Housing
- 10.020—Tiller Drive Gear
- 10.030—Tiller Drive Shaft
- 10.050—Tiller Depth Runner
- 10.060—Tiller Tine Spring Holder
- 10.070—Tiller Tine Holder Spring
- 10.075—Tiller Tines

14—STEERING

- 14.000—Handle Bar Base and Sector
- 14.005—Handle Bar Base
- 14.020—Handle Bar
- 14.030—Handle Bar Horizontal Control
- 14.040—Handle Bar Vertical Control

16—WHEELS AND WHEEL HUB CLUTCH

- 16.000—Wheels
- 16.010—Wheel Hub (Outer)
- 16.200—Hub Clutch Kit
- 16.210—Wheel Hub
- 16.215—Wheel Hub Bearing
- 16.220—Hub Clutch Seals
- 16.225—Wheel Control Clutch Race
- 16.230—Clutch Control Shoe and Shaft
- 16.235—Hub Control Plug and Lever
- 16.240—Hub (Inner)
- 16.245—Energizer
- 16.250—Clutch Actuating Spring
- 16.255—Clutch Control Handles
- 16.260—Clutch Control Cables and Clamps
- 16.270—Hub Assembly—Wheel—Direct Drive

18—SHEET METAL

- 18.000—Tiller Hood Assembly
- 18.010—Tiller Hood
- 18.020—Tiller Hood Adjusting Bar

20—TOOLS

- 20.000—Tools

50—STANDARD PARTS

- 50.000—Standard Parts

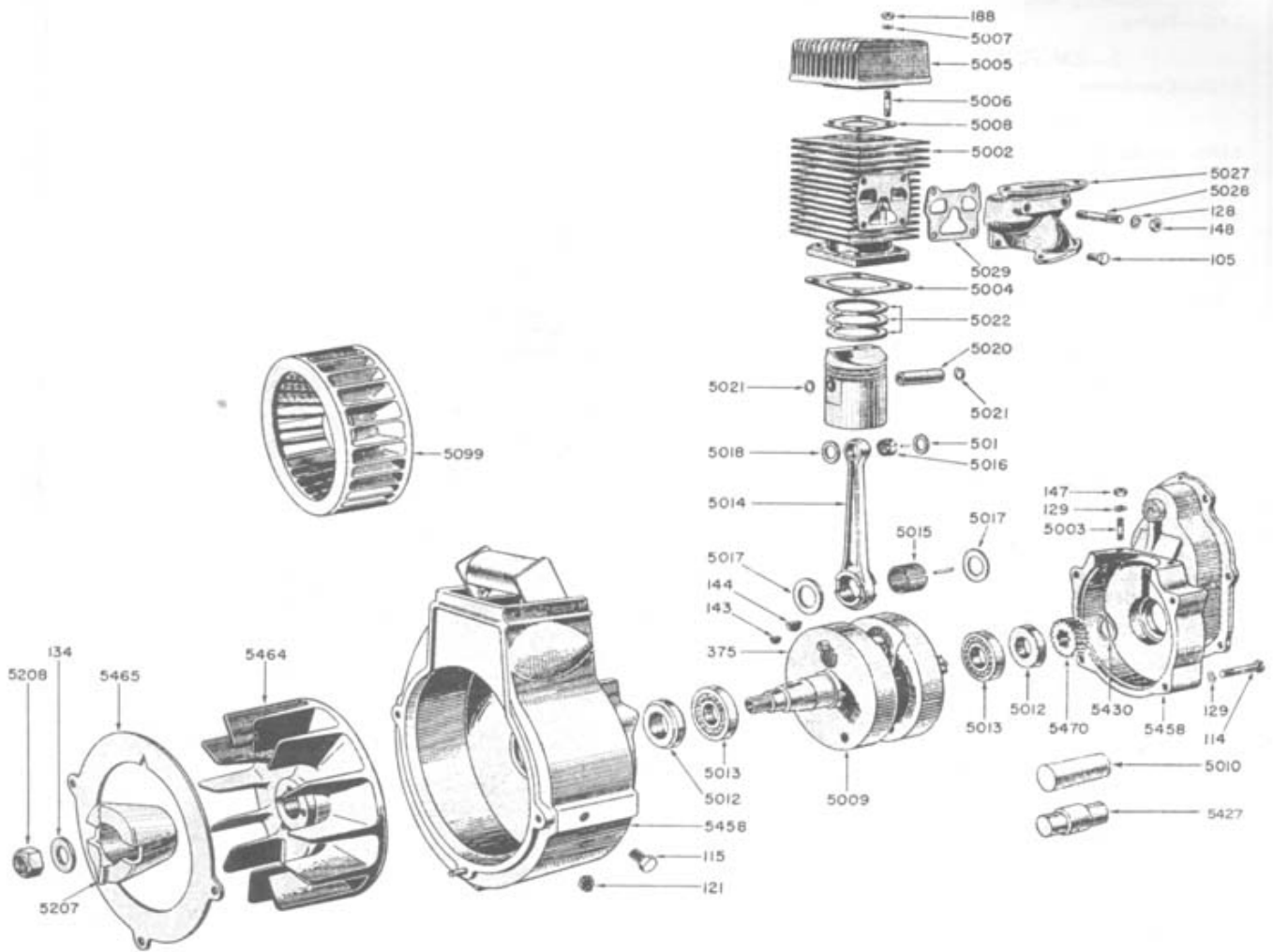

EXPLODED ENGINE ASSEMBLY

ROTOTILLER POWER TILLER

Illust.		NAME and DESCRIPTION	Models B1	Part Number	Qty.
Fig.	Item				
		1.—ENGINE			
		1.000—ENGINE			
		NOTE: Includes all items listed in Groups 1.100 thru 2.100 plus 6.000 and 7.220.			
		Engine (less accessories)..... Includes Crankcase, Crankshaft and Bearings, Cylinder Block, Cylinder Head, Connecting Rod and Bearing, Piston, Pin and Rings, Cooling Fan, Starting Dog and Crankshaft Gear.	All	5001	1
		Engine Gasket Kit		5950	1
		1.100—CYLINDER BLOCK			
		Block, Cylinder.....	All	5002	1
		Stud, $\frac{3}{8}$ "-16 x $\frac{3}{8}$ "-24 x $1\frac{5}{16}$ ".....	All	5003	4
		Lockwasher, $\frac{3}{8}$ ".....	All	129	4
		Nut, $\frac{3}{8}$ "-24 Hx.....	All	147	4
		Gasket, Cylinder Block.....	All	5004	1
		1.200—CYLINDER HEAD			
		Head, Cylinder.....	All	5005	1
		Stud, $\frac{3}{8}$ "-16 x $\frac{3}{8}$ "-24 x $2\frac{5}{32}$ ".....	All	5006	4
		Flatwasher, $2\frac{3}{64}$ " x $2\frac{3}{32}$ " x $\frac{1}{16}$ ".....	All	5007	4
		Nut, $\frac{3}{8}$ "-24 Hx.....	All	147	4
		Gasket, Cylinder Head.....	All	5008	1
		1.300—CRANKSHAFT			
		Crankshaft Assembly (includes next two items).....	All	5009	1
		Crankpin, Crankshaft, Straight Type, before Engine No. B66-4201.....	6; 6RS	5010	1
		Cap Screw, $\frac{1}{2}$ "-20 x $1\frac{1}{2}$ ", Socket Head (use with 5010).....	All	5011	2
		Crankpin, Crankshaft, Step Type after No. B66-4209.....	All	5427	1
		Set Screw, use with 5427.....	All	375	2
		Oil Seal, Crankshaft—(front and rear).....	All	5012	2
		Bearing, Crankshaft—(front and rear).....	All	5013	2
		Gear, 20 Teeth Helical—use before Engine No. B66-34051.....	6; 7	5023	1
		Gear, 20 Teeth Spur—use after Engine No. B66-34051 on B1-6.....	6RS; 7; 7A; 7RS;	5470	1
		Snap Ring.....	7RA All	5430	2
		1.400—CONNECTING ROD			
		Connecting Rod.....	All	5014	1
		Bearing, Connecting Rod (needle type).....	All	5015	25
		Bearing, Connecting Rod Piston Pin (needle type).....	All	5016	22
		Thrustwasher, Connecting Rod Bearing.....	All	5017	2
		Thrustwasher, Connecting Rod Piston Pin Bearing.....	All	5018	2
		1.410—PISTON			
		Piston.....	All	5019	1
		Pin, Piston.....	All	5020	1
		Lockring, Piston Pin.....	All	5021	2
		†Ring, Piston with Pin Groove.....	All	5022	3
		†Note: Piston Ring 5022 may be used with either 5019 or 5503.			

POWER TILLER OF A HUNDRED USES

Illust.		NAME and DESCRIPTION	Models B1	Part Number	Qty.
Fig.	Item				
2.—ENGINE LUBRICATION					
2.100—CRANKCASE					
NOTE: Includes Dowel Pin 5102 in Group 6.010 plus Bolt and Plugs listed below:					
Crankcase includes Blower Housing, Dowel Pins, Drain Plug, Side Bolts, Attaching Bolts and Lockwashers and Magneto Shaft Bearing					
		Bolt, $\frac{1}{2}$ "-13 x 1" Hx. Hd.	All	5458	1
		Plug, $\frac{3}{8}$ " Pipe Sq. Hd., Crankcase Drain	All	115	2
		Bolt, $\frac{3}{8}$ "-16 x 2 $\frac{3}{4}$ " Hx. Hd.—Front to Rear Case	All	121	1
		Lockwasher, $\frac{3}{8}$ " Med.—Front to Rear Case	All	114	4
		Bolt, $\frac{3}{16}$ "-16 x 1 $\frac{3}{8}$ " Hx. Hd.—Engine to Transmission	All	129	4
		Lockwasher, $\frac{3}{8}$ " Med.—Engine to Transmission	All	113	6
		Nut, $\frac{3}{8}$ "-16 Hx. Hd.—Engine to Transmission	All	129	6
		Cap Screw, $\frac{3}{8}$ "-16 x 1"—Engine to Reverse Gear Unit	All	146	6
		Lock Washer, $\frac{3}{8}$ "—Engine to Reverse Gear Unit	6RS: 7RS: 7RA	566	6
		Gasket—Engine to Transmission or Reverse Gear Unit	6RS: 7RS: 7RA	129	6
		Insert, Crankcase Ring	All	5228	1
			All	5803	2
3.—FUEL SYSTEM					
3.000—INTAKE MANIFOLD					
		Manifold, Intake and Exhaust	All	5027	1
		Stud, $\frac{5}{16}$ "-18 x $\frac{5}{16}$ "-24 x 4 $\frac{1}{8}$ "	All	5028	2
		Bolt, $\frac{5}{16}$ "-18 x 1 $\frac{1}{8}$ " Hx. Hd.	All	105	2
		Lockwasher, $\frac{5}{16}$ "	All	128	2
		Nut, $\frac{5}{16}$ "-24 Hx. Brass	All	148	2
		Gasket, Intake and Exhaust Manifold	All	5029	1
3.200—CARBURETOR					
NOTE: Includes items listed in Groups 3.210 thru 3.290.					
		Carburetor	All	5030	1
		Bolt, $\frac{5}{16}$ "-18 x $\frac{7}{8}$ " Hx. Hd.	All	103	2
		Lockwasher, $\frac{5}{16}$ "	All	128	2
		Gasket, Carburetor to Manifold	All	5031	1
		Dispenser, Fuel Vapor	All	5032	1
		Control Assembly, Choke (includes housing and wire)	All	5033	1
3.210—CARBURETOR MAIN BODY					
		Main Body, Carburetor (includes choke shaft bushings)	All	5034	1
		Drain Plug, Carburetor Bowl ($\frac{1}{8}$ " pipe sq. hd.)	All	5035	1
3.220—CARBURETOR CHOKE VALVE					
		Valve, Carburetor Choke	All	5036	1
		Screw, Carburetor Choke Valve	All	5037	2
		Lever and Shaft Assembly, Carburetor Choke Valve (includes swivel and screw)	All	5038	1
		Screw, No. 6-32 x $\frac{5}{16}$ " Fil. Hd. (swivel)	All	5039	1
		Spring, Carburetor Choke Valve Lever Return	All	5040	1
		Plug, Carburetor Choke Valve Shaft	All	5041	1
		Seal, Carburetor Choke Valve Shaft	All	5042	1
		Washer, Choke Valve Seal Retainer	All	5043	1
3.230—CARBURETOR CHOKE CONTROL BRACKET					
		Bracket, Carburetor Choke Control	All	5044	1
		Clamp, Carburetor Choke Control	All	5045	1
		Screw and Nut	All	5046	1

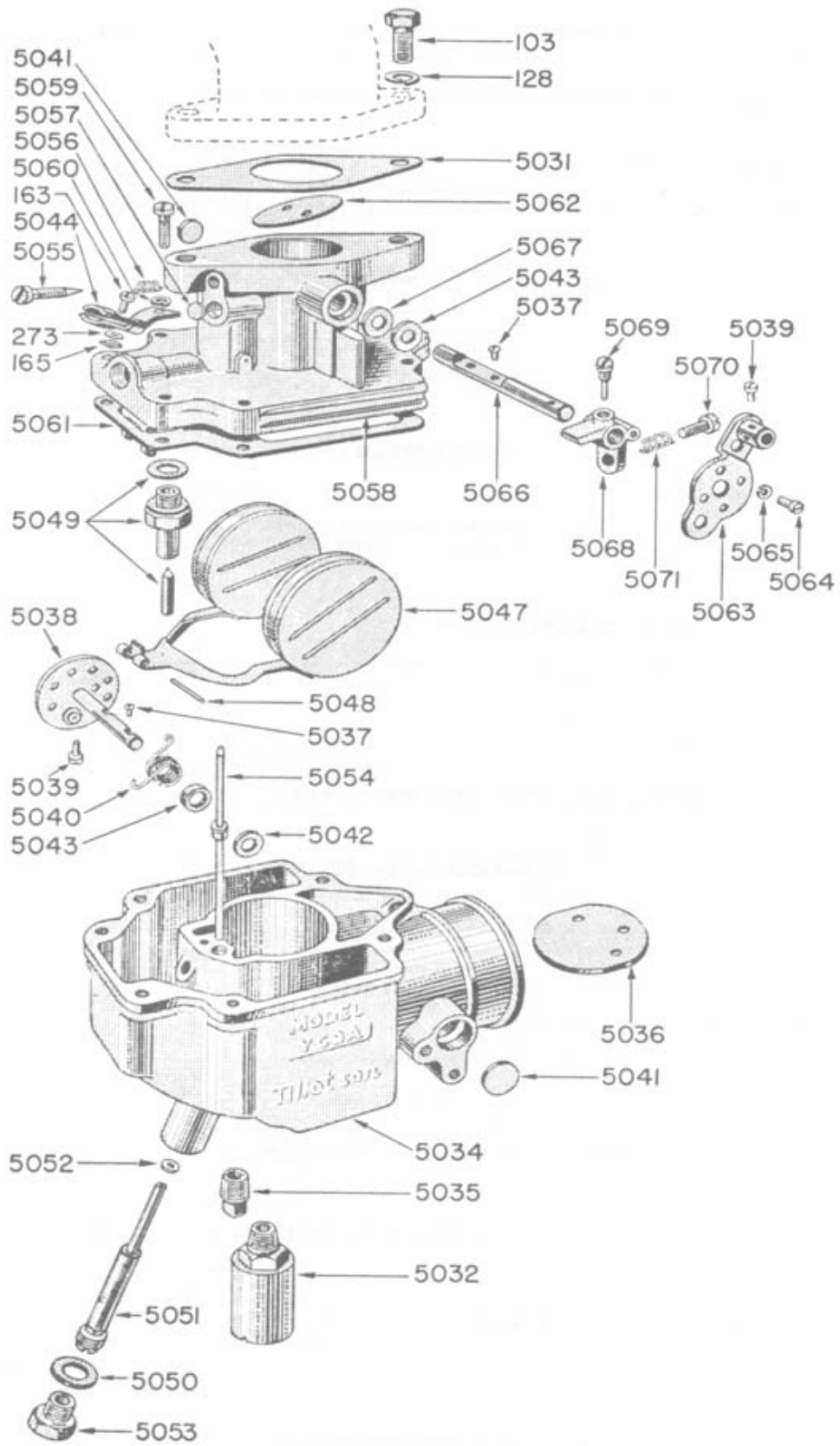

EXPLODED CARBURETOR ASSEMBLY

ROTOTILLER POWER TILLER

Illust.		NAME and DESCRIPTION	Models B1	Part Number	Qty.
Fig.	Item				
		3.240—CARBURETOR FLOAT, NEEDLE VALVE AND SEAT ASSEMBLY			
		Float, Carburetor (includes lever).....	All	5047	1
		Lever Pin, $\frac{3}{32}$ " x $2\frac{3}{32}$ ".....	All	5048	1
		Needle and Seat Assembly, Carburetor Float (includes gasket).....	All	5049	1
		Gasket, Carburetor Float Needle Valve Seat.....	All	5050	1
		3.250—CARBURETOR MAIN DISCHARGE NOZZLE			
		Nozzle, Carburetor Main Discharge.....	All	5051	1
		Gasket, Carburetor Main Discharge Nozzle.....	All	5052	1
		Plug, Carburetor Main Discharge Nozzle.....	All	5053	1
		Gasket, Carburetor Main Discharge Nozzle Plug.....	All	5050	1
		3.260—CARBURETOR IDLE TUBE AND NEEDLE			
		Tube, Carburetor Idle.....	All	5054	1
		Screw, Carburetor Idle Adjusting.....	All	5055	1
		Spring, Carburetor Idle Adjusting Screw.....	All	5056	1
		Plug, Carburetor Idle Passage ($\frac{1}{4}$ " Welch).....	All	5057	1
		3.270—CARBURETOR THROTTLE BODY			
		Throttle Body, Carburetor (includes throttle shaft bushings).....	All	5058	1
		Screw, No. 10-32 x $\frac{3}{4}$ " Fil. Hd.....	All	5059	6
		Lockwasher, $\frac{3}{16}$ ".....	All	5060	6
		Gasket, Carburetor Throttle Body.....	All	5061	1
		3.280—CARBURETOR THROTTLE VALVE AND LEVER			
		Valve, Carburetor Throttle.....	All	5062	1
		Screw, No. 6-32 x $\frac{1}{4}$ " Rd. Hd. Sl.....	All	5037	2
		Lever Assembly, Carburetor Throttle Shaft (includes swivel and screw).....	All	5063	1
		Screw, No. 8-32 x $\frac{3}{16}$ " Fil. Hd.....	All	5064	1
		Lockwasher, No. 8.....	All	5065	1
		Screw, No. 6-32 x $\frac{3}{16}$ " Fil. Hd. (swivel).....	All	5039	1
		Shaft, Carburetor Throttle Valve.....	All	5066	1
		Plug, Carburetor Throttle Valve Shaft.....	All	5041	1
		Seal, Carburetor Throttle Valve Shaft.....	All	5067	1
		Washer, Carburetor Throttle Valve Seal Retainer.....	All	5043	1
		Stop, Carburetor Throttle Lever.....	All	5068	1
		Screw, No. 10-32 x $1\frac{1}{2}$ " Fil. Hd. Dog Pt.....	All	5069	1
		Screw, No. 8-32 x $\frac{1}{2}$ " Fil. Hd. (throttle lever adjusting).....	All	5070	1
		Spring, Throttle Lever Adjusting.....	All	5071	1
		3.285—CARBURETOR THROTTLE CONTROL BRACKET			
		Bracket, Throttle Control.....	All	5072	1
		Clamp, Throttle Control.....	All	5045	1
		Screw and Nut.....	All	5046	1
		Clip, Throttle Control (intermediate).....	All	5074	1
		3.290—CARBURETOR REPAIR KITS			
		Repair Kit, Carburetor.....	All	5103	*
		Gasket Set, Carburetor.....	All	5104	*
		*NOTE: Repair Kit #5103 Includes Gasket Set #5104.			

POWER TILLER OF A HUNDRED USES

Illust.		NAME and DESCRIPTION	Models B1	Part Number	Qty.
Fig.	Item				
3.330—THROTTLE CONTROL					
	Lever, Throttle Control.....	All	5501	1	
	Pin, Throttle Control Lever.....	All	5076	1	
	Lockring, Throttle Control Lever Pin.....	All	5077	1	
	Flatwasher, 1/4" Small.....	All	130	1	
	Wire and Housing, Throttle Control.....	All	5078	1	
	Retainer, Throttle Control Wire.....	All	5079	1	
	Screw, No. 8-32 x 1/4" Fil. Hd.....	All	155	1	
	Clip, Throttle Control Wire (after Serial No. 23795 on B1-6, No. 51497 on B1-6RS).....	All	5502	1	
	Screw, No. 10-32 x 3/8" Fil. Hd. (lever end).....	All	118	1	
	Nut, No. 10-32 Sq.....	All	145	1	
3.550—FUEL STRAINER					
	Fuel Strainer (includes next 8 items).....	All	5080	1	
	Cover, Fuel Strainer.....	All	5081	1	
	Packing, Fuel Strainer Shut Off Valve.....	All	5084	1	
	Screen, Fuel Strainer.....	All	5085	1	
	Bowl, Fuel Strainer.....	All	5086	1	
	Gasket, Fuel Strainer Bowl.....	All	5087	1	
	Clamp Wire and Thumb Nut, Fuel Strainer Bowl.....	All	5088	1	
	Shutoff Valve and Packing Nut Assy.....	All	5831	1	
3.600—FUEL TANK					
	Fuel Tank (9 quarts).....	6; 6RS	5089	1	
	Fuel Tank (9 quarts).....	7; 7A; 7RS; 7RA	5635	1	
	Bolt, 5/16"-18 x 1/2" Rd. Hd. Sl.....	All	116	6	
	Lockwasher, 5/16".....	All	128	6	
	Cap, Fuel Tank.....	All	5090	1	
	Line, Fuel (with nuts).....	All	5091	1	
	Nut, 3/16"-20 x 1/4" Flared Tube.....	All	5505	2	
	Elbow, 3/16"-20 x 1/4" Flared Tube.....	All	5506	2	
	Bracket, connects Air Cleaner to Fuel Tank.....	7; 7RS; 7A; 7RA	5636	1	
	Bolt 1/4"-28 x 78" HX. HD.....	7; 7RS	202	4	
	Nut 1/4"-28 Elastic Stop.....	7; 7RS	5607	4	
4.—AIR INTAKE SYSTEM					
4.000—AIR CLEANER					
	Air Cleaner, Oil Bath (includes cup and spring).....	6; 6RS	5092	1	
	Air Cleaner, Oil Bath (includes cup and spring).....	7; 7RS; 7A; 7RA	5606	1	
	Bolt, 1/4"-20 x 1/2" Hx. Hd.—To Handle Bar Base.....	6; 6RS	101	3	
	Lockwasher, 1/4"—To Handle Bar Base.....	6; 6RS	127	3	
	Cup, Air Cleaner Oil.....	6; 6RS	5093	1	
	Cup, Air Cleaner Oil.....	7; 7RS; 7A; 7RA	5664	1	
	Spring, Clamp.....	All	5094	2	
	Tube, Air Cleaner to Carburetor.....	6; 6RS	5095	1	
	Tube, Air Cleaner to Carburetor.....	7; 7RS; 7A; 7RA	5609	1	
	Clamp, 1 1/8"—For use with Moulded Type Tube.....	All	5096	2	
	Clamp 1 1/8"—For use with Flexible Type Tube.....	All	201	2	
	Bolt 1/4"-28 x 3/16"—To Fuel Tank.....	7; 7RS; 7A; 7RA	202	2	
	Nut 1/4"-28—To Fuel Tank.....	7; 7RS; 7A; 7RA	5607	2	
5.—EXHAUST SYSTEM					
5.000—EXHAUST MANIFOLD					
	Manifold, Exhaust and Intake.....	All	5027	1	
	Stud, 5/16"-18 x 5/16"-24 x 4 1/8".....	All	5028	2	
	Bolt, 5/16"-18 x 1 1/8" Hx. Hd.....	All	105	2	
	Lockwasher, 5/16".....	All	128	2	
	Nut, 5/16"-24 Hx. Brass.....	All	148	2	
	Gasket, Exhaust and Intake Manifold.....	All	5029	1	

ROTOTILLER POWER TILLER

Illust.		NAME and DESCRIPTION	Models B1	Part Number	Qty.
Fig.	Item				
5.040—EXHAUST MUFFLER					
	Muffler		All	5952	1
	Bolt, $\frac{3}{8}$ "-16 x 1" Hx. Hd. Brass		All	112	2
	Lockwasher, $\frac{3}{8}$ "		All	129	2
	Gasket, Muffler to Manifold		All	5098	1
6.—ENGINE COOLING					
6.000—COOLING FAN					
	Fan, Cooling		All	5464	1
	Key, $\frac{3}{4}$ " x $\frac{7}{8}$ " (Woodruff No. A)		All	144	1
	Baffle, Fan		All	5465	1
6.010—COOLING FAN HOUSING					
	Housing, Cooling Fan—When used before Serial No. 27260 on B1-6; 51921 on B1-6RS, it is necessary to order one (1) Clevis Pin No. 5489.		All	5491	1
	Screen, Cooling Fan Housing		All	5101	1
	Bolt, $\frac{3}{8}$ "-16 x $1\frac{3}{8}$ " Hx. Hd		All	113	2
	Flatwasher, $\frac{3}{8}$ "		All	131	2
	Dowel Pin, Housing Locating		All	5102	1
	Fitting, Starter Shaft Grease		All	5486	1
7.—ELECTRICAL					
7.000—MAGNETO					
NOTE: Fairbanks Morse Magneto and Parts are indicated by letters F.M. and Edison-Splittdorf by letters E.S., and include items in Groups 7.002 thru 7.105 except Switch on Handle Bar.					
	Magneto (F.M.)		All	5105	1
	Magneto (E.S.)		All	5106	1
	Bolt, $\frac{1}{4}$ "-20 x $\frac{1}{2}$ " Hx. Hd. (F.M.)		All	366	4
	Bolt, $\frac{3}{8}$ "-16 x $\frac{1}{2}$ " Hx. Hd. (E.S.)		All	107	2
	Lockwasher, $\frac{1}{4}$ "		All	127	4
	Lockwasher, $\frac{3}{8}$ "		All	129	2
7.002—MAGNETO HOUSING WASHER					
	Washer, Magneto Housing Felt (E.S.)		All	5368	3
	Retainer, Magneto Housing Felt Washer (E.S.)		All	5369	2
7.005—MAGNETO COVERS					
	Cover, Magneto End (F.M.)		All	5107	1
	Screw		All	5108	4
	Flatwasher		All	5109	4
	Cover, Magneto Housing (includes Gasket) (E.S.)		All	5148	1
	Screw, No. 8-32 x $1\frac{1}{8}$ " Fil. Hd		All	5149	4
	Washer, Sealing		All	5150	4
	Cover, Magneto Breaker (includes gasket) (E.S.)		All	5152	1
	Screw, No. 8-32 x $\frac{3}{8}$ "		All	5153	4
	Lockwasher, No. 8		All	5154	4
	Gasket, Magneto End Cover (F.M.)		All	5110	1
	Gasket, Magneto Housing Cover (E.S.)		All	5151	1
	Gasket, Magneto Breaker Cover (E.S.)		All	5155	1

POWER TILLER OF A HUNDRED USES

Illust.		NAME and DESCRIPTION	Models B1	Part Number	Qty.
Fig.	Item				
7.010—MAGNETO CONTACT POINT SET					
		Point Set, Magneto Contact (includes arm, bracket and cam wick) (F.M.)	All	5111	1
		Screw, Contact Bracket Adjusting	All	5112	1
		Flatwasher, Contact Bracket Screw	All	5113	1
		Point Set, Magneto Contact (includes arm and bracket) (E.S.)	All	5156	1
		Screw, Contact Bracket	All	5157	2
7.015—MAGNETO CONTACT BREAKER CAM					
		Cam, Magneto Contact Breaker (E.S.)	All	5158	1
		Key	All	5159	1
		Screw, No. 6-32 x $\frac{5}{8}$ " Fil. Hd.	All	5160	1
		Flatwasher, No. 6	All	5161	1
		Lockwasher, No. 6	All	5162	1
		Wick, Magneto Cam Felt (F.M.)	All	5354	1
		Spacer, Tubular	All	5355	1
		Flatwasher	All	5356	1
		Screw	All	5357	1
		Wick, Magneto Cam Felt (E.S.)	All	5370	1
		Screw, No. 8-32 x $\frac{1}{4}$ " Rd. Hd.	All	5371	1
		Lockwasher, No. 8	All	5154	1
7.020—MAGNETO CONDENSER					
		Condenser, Magneto (F.M.)	All	5114	1
		Screw	All	5115	1
		Lockwasher	All	5116	1
		Condenser, Magneto (E.S.)	All	5163	1
		Screw, No. 8-32 x $\frac{5}{16}$ "	All	5164	1
		Lockwasher, No. 8	All	5154	1
7.025—MAGNETO ROTOR					
		Rotor, Magneto (F.M.)	All	5117	1
		Rotor, Magneto (E.S.)	All	5165	1
		Bearing, Magneto Rotor Thrust (F.M.)	All	5118	1
		Snap Ring, Inner	All	5119	1
		Snap Ring, Outer	All	5120	1
		Bearing, Magneto Rotor Thrust (E.S.)	All	5166	2
		Shim, Magneto Rotor Thrust Bearing (F.M.)	All	5121	2
		Shim, Magneto Rotor Thrust Bearing .002 (E.S.)	All	5167	1
		Shim, Magneto Rotor Thrust Bearing .003 (E.S.)	All	5168	1
		Washer, Magneto Rotor Thrust Bearing Insulating (F.M.)	All	5122	2
		Strip, Magneto Rotor Thrust Bearing Insulating (F.M.)	All	5123	1
		Seal, Magneto Rotor Thrust Bearing (F.M.)	All	5124	1
		Washer, Inner	All	5125	1
		Washer, Outer	All	5126	1
		Ring, Magneto Rotor Bearing Grease Sealing	All	5372	1
7.035—MAGNETO ROTOR FRONT PLATE					
		Plate and Bushing, Magneto Rotor Front Bearing (includes cam wick) (F.M.)	All	5358	1
		Screw	All	5359	4
		Plate, Magneto Rotor Front Bearing (includes ground switch) (E.S.)	All	5373	1
		Screw, No. 10-32 x $\frac{3}{8}$ " Fil. Hd.	All	5374	3
		Lockwasher, No. 10	All	5375	3

ROTOTILLER POWER TILLER

Illust.		NAME and DESCRIPTION	Models B1*	Part Number	Qty.
Fig.	Item				
		7.040—MAGNETO GROUND SWITCH			
		*Ground Lead Kit, Magneto (F.M.)	All	5361	1
		*Ground Lead Kit, Magneto (E.S.)	All	5376	1
		Screw, Magneto Ground Terminal (E.S.)	All	5377	1
		Shakeproof Washer, No. 6	All	5378	1
		Switch and Knob, Magneto Ground (E.S.)	All	5379	1
		Rivet, Tubular	All	5380	1
		Knob, Magneto Ground Switch (F.M.)	All	5362	1
		Nut, No. 6-32 Special	All	5363	1
		Spring, Magneto Ground Switch Knob (F.M.)	All	5364	1
		Wire, Magneto Ground (includes terminals) (F.M.)	All	5365	1
		SWITCH ON HANDLE BAR			
		Switch, Magneto Stop (includes terminal screw, insulator, washers, knob, spring, nuts, mounting plate and wire)	All	5384	1
		Screw, No. 6 x 3/4" Rd. Hd. Self Tapping	All	237	2
		Knob, Magneto Stop Switch	All	5362	1
		Screw, No. 6-32 x 5/8"	All	204	1
		Nut, No. 6-32 Special	All	5363	1
		Spring, Magneto Stop Switch Knob	All	5364	1
		Wire, Magneto Stop Switch (includes terminals)	All	5385	1
		Nut, No. 6-32 Hx. (F.M. only)	All	228	1
		7.045—MAGNETO FIELD COIL			
		Coil, Magneto Field (F.M.)	All	5127	1
		Screw	All	5128	2
		Flatwasher	All	5171	2
		Lockwasher	All	5154	2
		Coil, Magneto Field (E.S.)	All	5169	1
		Screw, No. 8-32 x 7/8" Fil. Hd.	All	5170	2
		Flatwasher, No. 8	All	5171	2
		Lockwasher, No. 8	All	5154	2
		Wire, Magneto Field Coil Primary Lead (includes terminal) (E.S.)	All	5172	1
		Insulator Magneto Field Coil (E.S.)	All	5381	1
		7.050—MAGNETO ADJUSTABLE COUPLING			
		Coupling, Magneto Adjustable (F.M.)	All	5366	1
		Key, 1/8" x 1/2" (Woodruff No. 3)	All	142	1
		Lockwasher	All	5132	1
		Coupling, Magneto Adjustable (E.S.)	All	5627	1
		Key, 1/8" x 1/2" (Woodruff No. 3)	All	142	1
		Lockwasher	All	5174	1
		Drive Member Magneto Adjustable Coupling (floating) (F.M.)	All	5134	1
		Drive Member, Magneto Adjustable Coupling (floating) (E.S.)	All	5626	1
		Locknut, Magneto Drive Collar	All	5666	1
		7.065—MAGNETO IMPULSE STARTER DRIVE MEMBER			
		†Starter, Magneto Impulse (F.M.) (20° lag. angle)	All	5367	1
		Key	All	5138	1
		Nut	All	5139	1
		Lockwasher	All	5140	1
		†Starter, Magneto Impulse (E.S.)	All	5177	1
		Key, 1/8" x 1/2" (Woodruff No. 3)	All	142	1
		Nut	All	5178	1
		Lockwasher	All	5179	1
		Lockwasher, 1/2"	All	5180	1
		*Includes, Ground Terminal, Screw, Bushings, Washers, Knob, Spring and Nuts.			
		°Includes, Ground Screw, Bushing, Washers and Ground Lead.			
		†Note: Includes hub, shell and spring.			
		‡Note: Includes levers, spring, hub and washers.			

POWER TILLER OF A HUNDRED USES

Illust.		NAME and DESCRIPTION	Models B1	Part Number	Qty.
Fig.	Item				
		7.065—MAGNETO IMPULSE STARTER DRIVE MEMBER			
		<i>(Continued)</i>			
		Drive Member, Magneto Impulse Starter (20° lag. angle) (E.S.).....	All	5176	1
		Plate, Magneto Impulse Starter Stop Pin (includes 3 screws) (E.S.)..	All	5181	1
		Screw, $\frac{3}{16}$ "-24 x $\frac{3}{8}$ " Fl. Hd.....	All	5182	3
		Seal, Magneto Impulse Starter Bearing Felt (E.S.).....	All	5383	1
		Seal, Magneto Impulse Starter (includes 2 screws and lockwashers) (E.S.).....	All	5183	1
		Screw, No. 6-32 x $\frac{1}{8}$ " Fil. Hd.....	All	5184	2
		Lockwasher, No. 6.....	All	5162	2
		7.105—MAGNETO IMPULSE STARTER HOUSING			
		Housing, Magneto Impulse Starter (F.M.).....	All	5141	1
		Screw, Flat Head.....	All	5143	2
		Washer, Magneto Impulse Starter Housing Felt (F.M.).....	All	5145	1
		Flatwasher.....	All	5142	1
		Cupped Washer, Magneto Impulse Starter Housing (F.M.).....	All	5146	1
		Screw, Self Tapping, Rd. Hd.....	All	5147	2
		7.115—MAGNETO MOUNTING PLATE			
		Plate, Magneto Mounting.....	All	5185	1
		Bolt, $\frac{3}{8}$ "-16 x $\frac{1}{2}$ " Hx. Hd.....	All	107	2
		7.120—MAGNETO DRIVE			
		Gear, Magneto Drive (20 Tooth Helical Gear).....	6; 7	5186	1
		Gear, Magneto Drive (20 Tooth Spur Gear).....	6RS; 7; 7A; 7RS; 7RA	5422	1
		Snap Ring, Magneto Drive Gear (use with 5422).....	All	5424	1
		Key, $\frac{1}{8}$ " x $\frac{1}{2}$ " (Woodruff No. 3).....	All	142	1
		Thrust Washer, Magneto Drive Gear.....	All	5133	1
		Spacer, Magneto Drive Shaft.....	6RS; 7RS; 7RA	5425	1
		Shaft, Magneto Drive Gear—(use with 5186 Gear).....	6; 7	5187	1
		Shaft, Magneto Drive Gear—(use with 5422 Gear).....	6; 7; 7A	5495	1
		Shaft, Magneto Drive Gear—(use with 5422 Gear).....	6RS; 7RS; 7RA	5423	1
		Snap Ring, Magneto Drive Shaft (use with 5495 and 5423 Shafts).....	All	5424	1
		Bearing, Magneto Drive Shaft—Rear (Needle Type).....	6; 6RS	5188	1
		Bearing, Magneto Drive Shaft—Rear (Bronze).....	7; 7A; 7RS; 7RA	5496	1
		Retainer, Magneto Drive Shaft Bearing (Cast Iron).....	6; 6RS	5205	1
		Oil Seal, Magneto Drive Shaft.....	All	5190	1
		Dowel Pin $\frac{1}{8}$ " x $\frac{5}{16}$ ".....	All	176	1
		Bearing, Magneto Drive Shaft—Front (Needle Type, Closed End).....	6; 6RS	5189	1
		Bearing, Magneto Drive Shaft—Front (Bronze Bushing).....	7; 7A; 7RS; 7RA	5497	1
		Plug, Magneto Drive Shaft Bearing $1\frac{3}{16}$ ".....	All	565	1
		Dowel Pin $\frac{5}{16}$ ".....	All	5226	1
		7.140—IGNITION CABLE AND SPARK PLUG			
		Cable, Spark Plug (with terminals).....	All	5191	1
		Spark Plug.....	All	5192	1
		Gasket, Spark Plug.....	All	5193	1
		Nipple, Spark Plug Cable (for Edison Splitdorf magneto).....	All	5194	1
		7.200—STARTER (MANUAL)			
		Starter Assy.....	All	5898	1
		Shaft, Starter Pulley.....	All	5196	1
		Spring, Starter Pulley Shaft.....	All	5196	1
		Locking Ring, Starter Pulley Shaft.....	All	5197	2

SECTION VII Manual Starting System

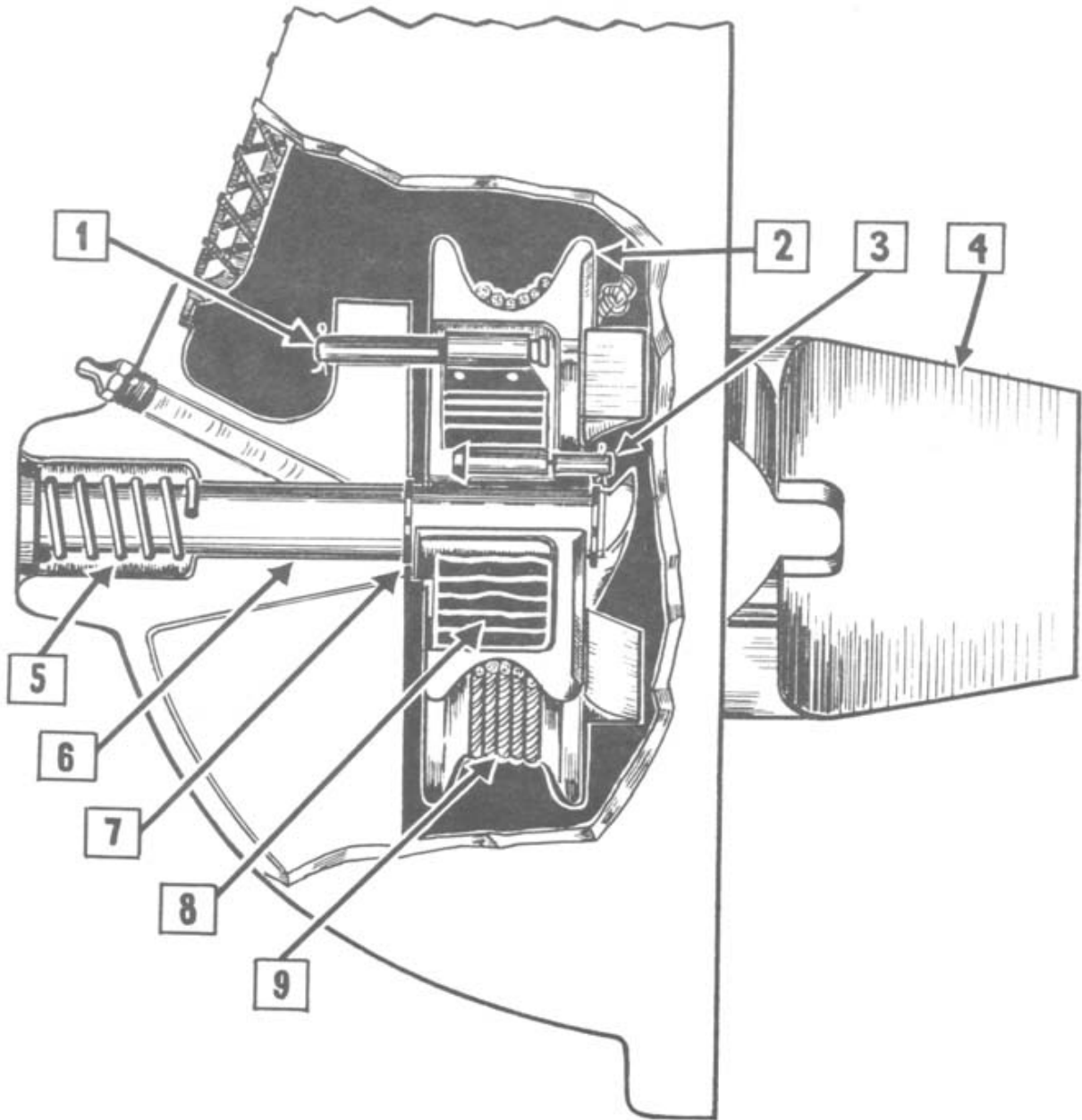

SECTIONAL VIEW OF STARTING ASSEMBLY—Complete Part No. 589B

1. Clevis Pin ((spring to casting) . . .	5489	All B1-7, 5201 All B1-6 Models
2. Pulley	5198	
3. Clevis Pin (spring to pulley)	5200	
4. Starting Dog	5207	
5. Shaft Spring	5196	
6. Starter Shaft	5195	
7. Shaft Snap Ring	5197	
8. Rewinding Spring	5199	
9. Starter Cable	5203	
10. Housing Cooling Fan	5491	
11. Screen	5101	

ROTOTILLER POWER TILLER

Illust.		NAME and DESCRIPTION	Models B1	Part Number	Qty.
Fig.	Item				
7.205—STARTER CABLE JAW SHEAVE					
		Jaw, Cable Sheave or Pulley.....	All	5198	1
		Spring, Cable Rewinding.....	All	5199	1
		Clevis Pin, Spring, 1 ⁷ / ₃₂ " Long.....	All	5200	1
		Clevis Pin, Spring, 1 ¹³ / ₁₆ " Long (use with 5100 Housing).....	6; 6RS	5201	1
		Clevis Pin, Spring, 1 ¹ / ₄ " x 3 ⁵ / ₈ " (use with 5491 Housing).....	7; 7RS; 7A; 7RA	5489	1
		Cotterpin, 1 ¹ / ₁₆ " x 1 ¹ / ₂ ".....	All	137	2
		Flat Washer, 1 ¹ / ₄ " Small (use with 5491 Housing).....	All	130	1
7.210—STARTER—CABLE					
		Cable, Starter.....	All	5203	1
		Grip, Starter Cable.....	6; 6RS	5204	1
		Grip, Starter Cable.....	7; 7RS; 7A; 7RA	5487	1
		Set Screw, 1 ¹ / ₄ "-20 x 1".....	6; 6RS	174	1
		Spring, Cable Guide.....	All	5206	1
7.220—STARTING DOG					
		Dog, Starting (crankshaft end).....	All	5207	1
		Key, 3 ¹ / ₁₆ " x 3 ³ / ₄ " (Woodruff No. 9).....	All	143	1
		Flatwasher, 3 ³ / ₄ " Small.....	All	134	1
		Nut, 3 ³ / ₄ "-16 Hx. (elastic stop).....	All	5208	1
STARTER HOUSING—See Cooling Fan Housing Group 6.010					
8.—CLUTCH					
8.000—TILLER CLUTCH DOG					
		Clutch Dog, Shift (on transmission worm shaft) (see page 15).....	All	5209	1
		Clutch Dog (on tiller drive pinion) (see page 21).....	All	5210	1
		Snap Ring, Drive Pinion Clutch Dog (see page 21).....	All	5211	1
8.005—TILLER CLUTCH SHOCK ABSORBER (see page 21)					
		Housing, Clutch Shock Absorber.....	All	5212	1
		Key, 1 ¹ / ₄ " x 3 ³ / ₈ " (Woodruff No. A).....	All	144	1
		Snap Ring.....	All	5213	1
		Thrustwasher, Clutch Shock Absorber Housing.....	All	5214	1
		Pad, Clutch Shock Absorber (leather).....	All	5215	8
8.010—TILLER CLUTCH CONTROL FORK (see page 15)					
		Fork, Shift Clutch Dog (before motor No. 4392).....	6	5216	1
		Key, 3 ¹ / ₈ " x 1 ¹ / ₂ " (Woodruff No. 3) (before motor No. 4392).....	6	142	1
		Set Screw, 3 ¹ / ₁₆ "-18 x 1 ¹ / ₂ " (cone point—self locking).....	All	5217	1
		Shoe, Clutch Dog Shift (before motor No. 4392).....	All	5610	2
		Fork and Shoe Assy, Clutch Dog Shift (after motor No. 4391 on B1-6).....	All	5500	1
		Key, 3 ⁵ / ₃₂ " x 3 ⁵ / ₈ " (Woodruff No. 6) (after motor No. 4391 on B1-6).....	All	175	1
8.015—TILLER CLUTCH CONTROL SHAFT (see page 15)					
		Shaft, Shift Clutch Dog (before motor No. 4392).....	6	5219	1
		Shaft, Shift Clutch Dog (after motor No. 4391 on B1-6).....	All	5451	1
		Lever, Shift Clutch Dog (before motor No. 4392).....	6	5220	1
		Lever, Shift Clutch Dog (after motor No. 4391 on B1-6).....	All	5452	1
		Key, 3 ¹ / ₈ " x 1 ¹ / ₂ " (Woodruff No. 3) (before motor No. 4392).....	6	142	1
		Key, 3 ⁵ / ₃₂ " x 3 ⁵ / ₈ " (Woodruff No. 6) (after motor No. 4391 on B1-6).....	All	175	1
		Set Screw, 3 ¹ / ₁₆ "-18 x 1 ¹ / ₂ " (cone point—self locking).....	All	5217	1
		Set Screw, 3 ¹ / ₁₆ "-18 x 3 ³ / ₈ " Sq. Hd. Cone Point (after motor No. 4391 on B1-6).....	All	332	1
		Lock Nut, 3 ¹ / ₈ "-18 (after motor No. 4391 on B1-6).....	All	333	1
		Trunnion, Shift Clutch Dog Lever.....	All	5221	1
		Flatwasher, 3 ¹ / ₁₆ " Small.....	All	177	1
		Cotterpin, 3 ⁵ / ₃₂ " x 3 ¹ / ₄ ".....	All	139	1
		Snap Ring Used with 5451.....	All	5263	1

POWER TILLER OF A HUNDRED USES

Illust.		NAME and DESCRIPTION	Models B1	Part Number	Qty.
Fig.	Item				
8.020—TILLER CLUTCH CONTROL ROD					
		Rod, Tiller Clutch Control (includes grip).....	6; 6RS	5222	1
		Rod, Tiller Clutch Control.....	7; 7RS; 7A; 7RA	5616	1
		Cotterpin, $\frac{3}{32}$ " x $\frac{3}{4}$ ".....	All	139	1
		Ball, Tiller Clutch Control Rod.....	7; 7RS; 7A; 7RA	5613	1
8.025—TILLER CLUTCH SHIFT LEVER LOCK SPRING					
		Lock Spring, Shift Lever.....	All	5223	1
		Lock Spring, Shift Lever Auxiliary.....	All	5224	1
		Bolt, $\frac{1}{4}$ "-20 x $\frac{5}{8}$ " Hx. Hd.....	All	102	2
		Lockwasher, $\frac{1}{4}$ ".....	All	127	2
		Shim, Shift Lever Lock Spring.....	All	5073	*
9.—TRANSMISSION					
9.000—TRANSMISSION					
NOTE: Includes 5209 Dog in Group 8.000 and 9.005 thru 9.065 plus 9.080, 9.085, 16.010. Does not include last four items in Group 9.050.					
		Transmission (includes items 5-6-8-9 listed below) less Shifting Levers and Arms, and Wheel Hubs.....	All	5442	1
		When used on B1-7 and B1-7RS, remove Inner Hub Oil Seals Part No. 5269.....			
		Dowel, Locating $\frac{3}{16}$ " x $1\frac{1}{16}$ ".....	All	5226	2
		Bolt, $\frac{3}{8}$ "-16 x $1\frac{3}{8}$ " Hx. Hd.....	All	113	6
		Lockwasher, $\frac{3}{8}$ ".....	All	129	6
		Nut, $\frac{3}{8}$ "-16 Hx.....	All	146	6
		Plug, $\frac{1}{2}$ " Sq. Hd. (filler and level gage).....	All	5227	1
		Plug, $\frac{1}{4}$ " Sq. Hd. (drain).....	All	120	2
		Gasket, Transmission Crankcase.....	All	5228	1
		Gage, Transmission Oil Level.....	All	5229	1
		Washer, Transmission Oil Level Gage Felt.....	All	5230	1
9.005—TRANSMISSION CASE					
NOTE: Includes Magneto Shaft Bearing and Oil Seal; Worm Shaft Rear Bearing Cup, High and Low Speed Gear Bushings and Shifter Forkshaft Oil Seal.					
		Case Assembly, Transmission.....	All	5231	1
		Cover, Transmission Case.....	All	5232	1
		Bolt, $\frac{3}{8}$ "-16 x $\frac{3}{4}$ " Hx. Hd.....	All	109	2
		Lockwasher, $\frac{3}{8}$ ".....	All	129	2
		Gasket, Transmission Case Cover.....	All	5233	1
		Plug, Expansion Pinion Shaft.....	All	5429	2
9.010—TRANSMISSION DRIVE GEAR					
		Gear, Transmission Drive (49 tooth helical gear).....	6; 7	5234	1
		Gear, Transmission Drive (49 tooth spur gear).....	6RS; 7; 7A; 7RS; 7RA	5498	1
		Spacer, Transmission Drive Gear.....	All	5235	1
		Snap Ring.....	All	5430	1
		Shaft, Transmission Worm.....	All	5236	1
		Bearing Cone, Worm Shaft Front.....	All	5237	1
		Bearing Cup, Worm Shaft Front.....	All	5238	1
		Bearing Cone, Worm Shaft Rear.....	All	5239	1
		Bearing Cup, Worm Shaft Rear.....	All	5240	1
		Retainer, Worm Shaft Front Bearing.....	All	5241	1
		Bolt, $\frac{3}{8}$ "-16 x $\frac{3}{4}$ " Hx. Hd. Drl'd.....	All	5242	4
		Shim, Worm Shaft Front Bearing Retainer (.020).....	All	5432	*
		Shim, Worm Shaft Front Bearing Retainer (.007).....	All	5433	*
		Shim, Worm Shaft Front Bearing Retainer (.005).....	All	5434	*

* As Required

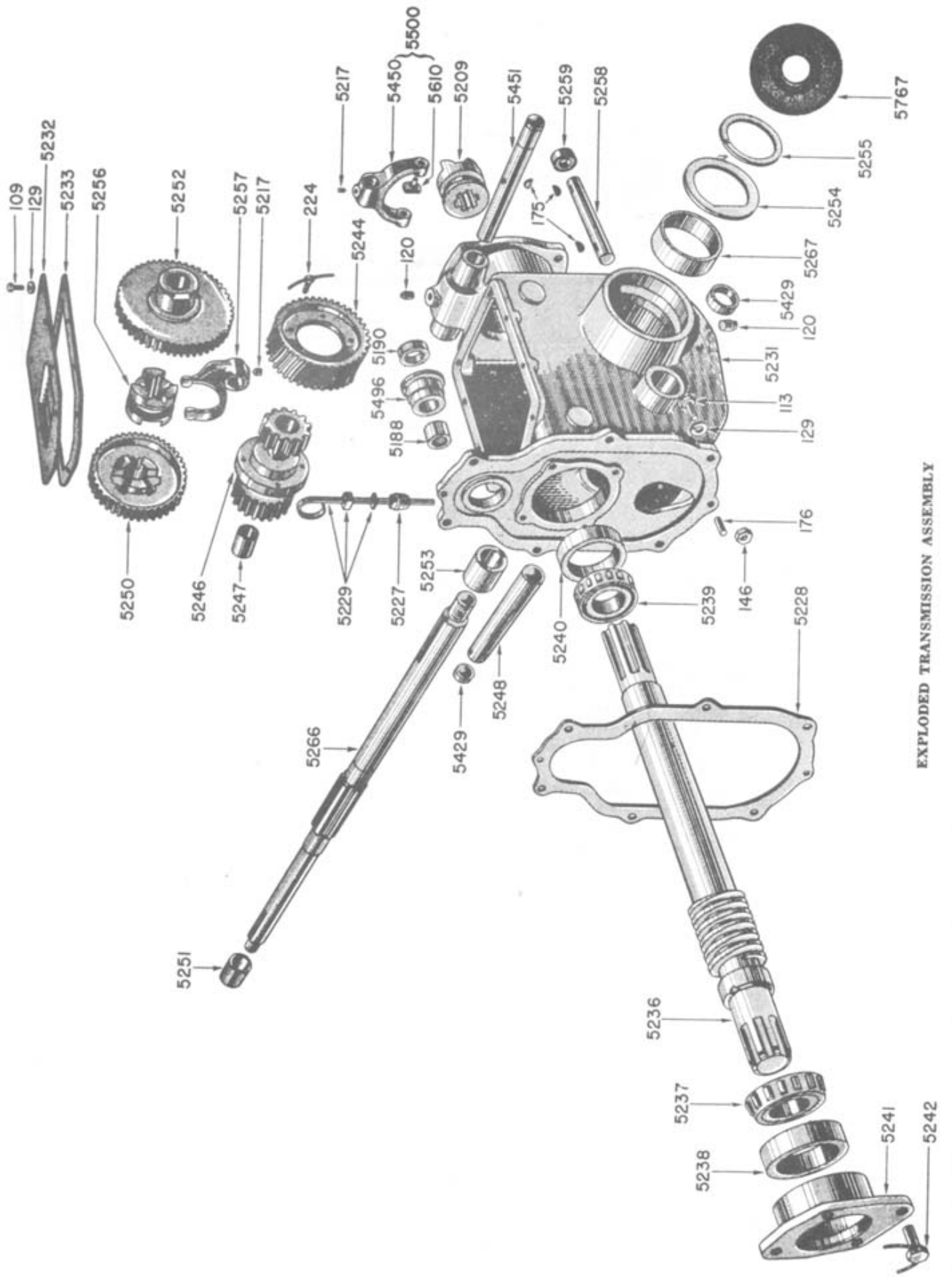

EXPLODED TRANSMISSION ASSEMBLY

ROTOTILLER POWER TILLER

Illust.		NAME and DESCRIPTION	Models B1	Part Number	Qty.
Fig.	Item				
9.020—TRANSMISSION WORM GEAR					
		Gear, Transmission Worm.....	All	5244	1
		Bolt, $\frac{3}{16}$ "-24 x $\frac{3}{4}$ " Hx. Hd. Drl'd.....	All	224	4
		Pinion, Transmission Worm Gear.....	All	5246	1
		Bushing, Transmission Worm Gear Pinion.....	All	5247	2
		Shaft, Transmission Pinion.....	All	5248	1
		Set Screw, $\frac{3}{16}$ "-18 x $\frac{1}{2}$ " (cone point—self-locking).....	All	5217	1
		Thrustwasher, Transmission Worm Gear Pinion, before motor No. 274.....	6	5249	1
9.030—TRANSMISSION GEARS (HIGH & LOW SPEED)					
		Gear, Transmission High Speed (with bushing).....	All	5250	1
		Bushing, Transmission High Speed Gear.....	All	5251	1
		Gear, Transmission Low Speed (with bushing).....	All	5252	1
		Bushing, Transmission Low Speed Gear.....	All	5253	1
		Thrustwasher.....	All	5254	2
		Snap Ring.....	All	5255	2
		Bushing, Transmission High and Low Speed Gear Outer.....	All	5267	2
9.040—TRANSMISSION GEARS (HIGH—HIGH SPEED)					
		Kit, High-High Speed.....	All	5943	1
		Gear, High-High Speed.....	All	5939	1
		Pinion, High-High Speed with bushing.....	All	5938	1
		Bushing, High-High Speed Pinion.....	All	5247	2
9.050—TRANSMISSION SHIFT MECHANISM					
		Sleeve, Transmission Shift.....	All	5256	1
		Fork, Transmission Shift.....	All	5257	1
		Key, $\frac{3}{32}$ " x $\frac{3}{8}$ " (Woodruff No. 6).....	All	175	1
		Set Screw, $\frac{3}{16}$ "-18 x $\frac{1}{2}$ " (cone point—self locking).....	All	5217	1
		Shaft, Transmission Shift Fork.....	All	5258	1
		Oil Seal, Transmission Shift Fork Shaft.....	All	5259	1
		Arm, Transmission Shift.....	6; 7; 7A	5260	1
		Arm, Transmission Shift.....	6RS; 7RS; 7RA	5447	1
		Key, $\frac{3}{32}$ " x $\frac{3}{8}$ " (Woodruff No. 6).....	All	175	1
		Set Screw, $\frac{3}{16}$ "-18 x $\frac{1}{2}$ " (cone point—self locking).....	All	5217	1
		Trunnion, Arm Shifter Control.....	All	5221	1
		Flatwasher, $\frac{3}{16}$ " Small.....	All	177	1
		Cotterpin, $\frac{3}{32}$ " x $\frac{3}{4}$ ".....	All	139	1
		Link Assy, Speed Shifter Control.....	6; 7; 7A	5431	1
		Link, Shift Control—Upper.....	6; 7; 7A	5386	1
		Nut, $\frac{3}{8}$ "-24 Hx.....	All	147	1
		Housing, Shift Control Link.....	All	5388	1
		Seat, Shift Control Link Spring.....	All	5389	1
		Pin, $\frac{1}{8}$ " x $1\frac{1}{16}$ " Sq. End Pl.....	All	245	1
		Spring, Shift Control Link.....	All	5390	2
		Cap, Shift Control Link Housing.....	All	5391	1
		Link, Shift Control—Lower.....	All	5387	1
		Cotterpin, $\frac{3}{32}$ " x $\frac{3}{4}$ ".....	All	139	2
9.065—TRANSMISSION SHIFT LEVER					
		Lever, Transmission Shift (includes bushing).....	6; 7; 7RA	5262	1
		Lever, Transmission Shift—Reverse (includes bushing).....	6RS; 7RS; 7RA	5457	1
		Lever, Transmission Shift—Reverse (includes Bushing) Used on all Reverse Gear Equipped Rototillers.....	W/stop assy #5918	5919	1
		Cotter Pin $5/32$ " x $1-3/8$ ".....	All	140	2
		Flatwasher, $\frac{3}{8}$ " Small.....	All	133	2
		Snap Ring.....	All	5263	2
		Bushing, Transmission Shift Lever.....	All	5264	1
		Trunnion, Transmission Shift Lever Control.....	All	5221	2
		Flatwasher, $\frac{3}{16}$ " Small.....	All	177	2
		Cotterpin, $\frac{3}{32}$ " x $\frac{3}{8}$ ".....	All	138	2
9.070—TRANSMISSION SHIFT CONTROL ROD					
		Rod, Transmission Shift Control (includes grip).....	6; 6RS	5265	1
		Rod, Transmission Shift Control.....	7; 7RS; 7A; 7RA	5615	1
		Ball Knob, Transmission Shift Control Rod.....	7; 7A	5613	1
		Ball Knob, Forward, Reverse Control Rod Used on all Reverse Gear Equipped Rototillers.....	W/stop assy #5918	5936	1
		Cotterpin, $\frac{3}{32}$ " x $\frac{3}{4}$ ".....	All	139	1

* As Required

POWER TILLER OF A HUNDRED USES

Illustr.		NAME and DESCRIPTION	Models BI	Part Number	Qty.
Fig.	Item				
		9.075—TRANSMISSION SHIFT LEVER LOCK SPRING			
		Lock Spring, Shift Lever	All	5223	1
		Lock Spring, Shift Lever Auxiliary	All	5224	1
		Bolt, $\frac{1}{4}$ "-20 x $\frac{3}{8}$ " Hx. Hd.	All	102	2
		Lockwasher, $\frac{3}{16}$ "	All	127	2
		Shim, Shift Lever Lock Spring	All	5073	*
		9.080—TRANSMISSION AXLE			
		Axle, Transmission (less bushings)	All	5266	1
		Spacer, Transmission Axle to Hub (used only with axles undercut between keyway and transmission case)	6: 6RS	5466	4
		9.085—WHEEL HUB (INNER) (For units with free wheeling)			
		Hub, Wheel Inner	6: 6RS	5268	2
		Key, $\frac{3}{16}$ " x $\frac{3}{16}$ " x $2\frac{1}{4}$ "	6: 6RS	5329	2
		Plug, Key	6: 6RS	5392	2
		Washer, Oil Seal, Wheel Inner Hub	All	5767	2
		Lockpin, Free Wheeling	6: 6RS	5270	2
		Spring, Free Wheeling Lockpin (short)	6: 6RS	5271	2
		Spring, Free Wheeling Lockpin (long)	6: 6RS	5272	2
		Bolt, $\frac{3}{16}$ "-18 x $\frac{3}{4}$ " Rd. Hd. Sl.	6: 6RS	117	2
		Flatwasher, $\frac{3}{16}$ " Small	6: 6RS	130	2
		Lockwasher, $\frac{3}{16}$ "	6: 6RS	128	2
		9.500—REVERSE GEAR			
		9.500—REVERSE GEAR CASE			
		Kit, Reverse Gear With Stop Assy.	6: 7: 7A B1-6; B1-7	5944	1
		Kit, Reverse Gear Installation		5426	1
		NOTE: Includes All Parts Necessary to Install Reverse Gear on B1-6 and B1-7 Models.			
		Case, Reverse Gear (includes dowel pins and pinion shaft bearing)	6RS: 7RS: 7RA	5399	1
		Cap Screw, $\frac{3}{8}$ "-16 x 1" Hx. Hd. { Reverse Gear	6RS: 7RS: 7RA	566	6
		Lockwasher, $\frac{3}{8}$ " { to Engine	6RS: 7RS: 7RA	129	6
		Cap Screw, $\frac{3}{8}$ "-16 x 1" Hx. Hd. { Transmission to	6RS: 7RS: 7RA	566	4
		Bolt, $\frac{3}{8}$ "-16 x $1\frac{1}{8}$ " Hx. Hd. { Reverse Gear	6RS: 7RS: 7RA	113	2
		Lockwasher, $\frac{3}{8}$ " { (See "Note A")	6RS: 7RS: 7RA	129	6
		Nut, $\frac{3}{8}$ "-16 Hx.	6RS: 7RS: 7RA	146	2
		Dowel, Case to Transmission ($\frac{3}{16}$ " x $1\frac{1}{16}$ "	6RS: 7RS: 7RA	5226	2
		Gasket, Case to Engine and Transmission	6RS: 7RS: 7RA	5228	2
		NOTE A: A number of units were produced with 6 cap screws instead of 4 cap screws and 2 bolts. Therefore a check must be made before replacing the parts.			
		Drive Assy., Reverse Gear	6RS: 7RS: 7RA	5398	1
		9.510—REVERSE GEAR DRIVE PINION			
		Pinion, Reverse Gear Drive (20 teeth) (couples with crankshaft)	6RS: 7RS: 7RA	5400	1
		Shaft, Reverse Gear Pinion (16 teeth)	6RS: 7RS: 7RA	5401	1
		Washer, $2\frac{1}{2}$ " I.D. x $1\frac{1}{8}$ " O.D.	6RS: 7RS: 7RA	5435	1
		Snap Ring	6RS: 7RS: 7RA	5197	1
		Bearing, Reverse Gear Pinion Shaft	6RS: 7RS: 7RA	5402	1
		9.520—REVERSE GEAR IDLER GEAR			
		Gear, Reverse Gear Idler (20 teeth) (includes needle bearing)	6RS: 7RS: 7RA	5403	1
		Shaft, Reverse Gear Idler Gear	6RS: 7RS: 7RA	5404	1
		Set Screw, $\frac{3}{16}$ "-18 x $\frac{3}{8}$ " Cup Pt.	6RS: 7RS: 7RA	595	1
		Bearing, Reverse Gear Idler Gear (needle)	6RS: 7RS: 7RA	5402	1
		* As Required			

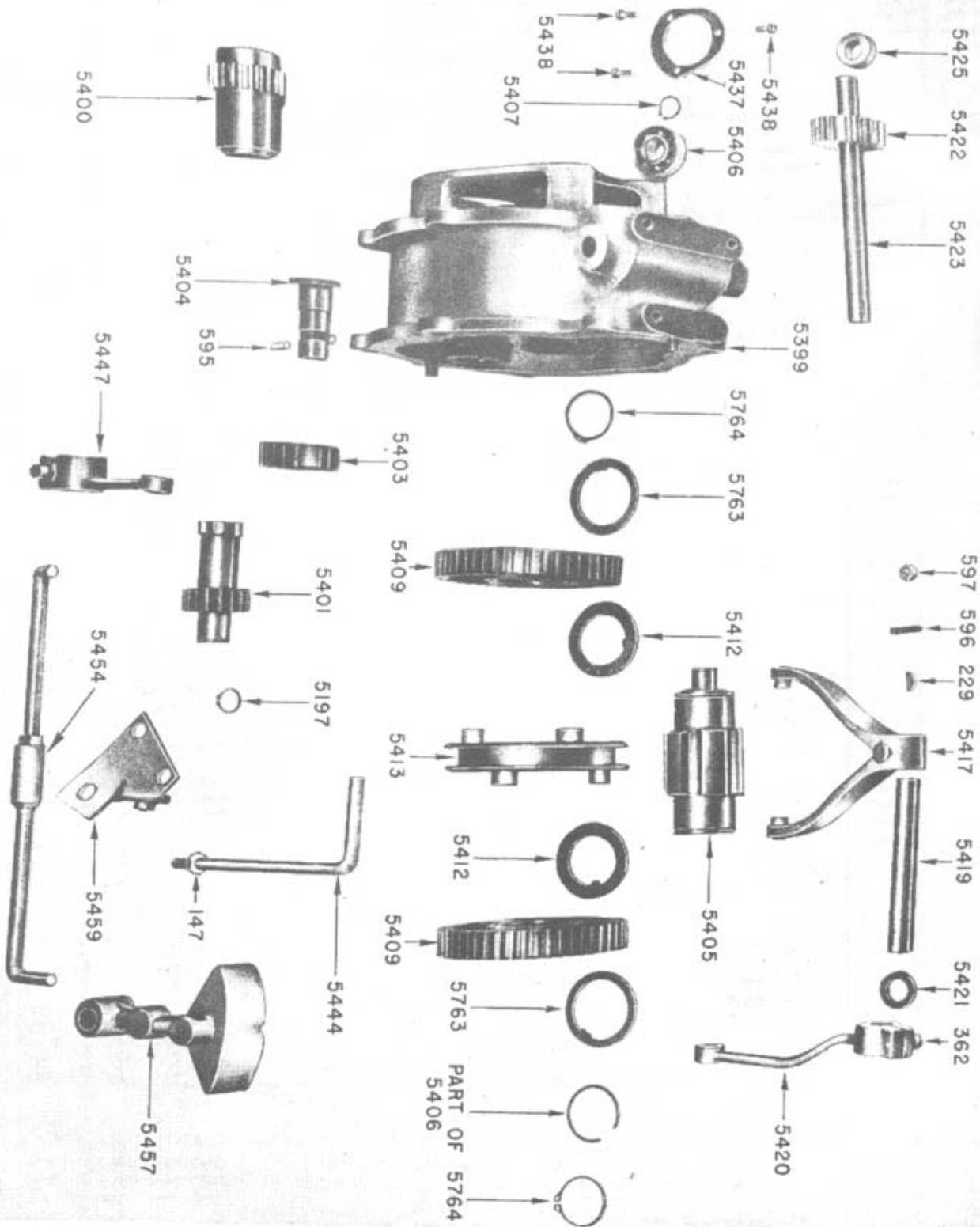

EXPLODED VIEW OF REVERSE GEAR

ROTOTILLER POWER TILLER

Illust.		NAME and DESCRIPTION	Models B1	Part Number	Qty.
Fig.	Item				
9.530—REVERSE GEAR WORM DRIVE GEAR AND SHAFT					
		Shaft, Reverse Gear Worm Gear Drive (couples with transmission shaft)	6RS; 7RS; 7RA	5405	1
		Bearing, Reverse Gear Worm Gear Drive Shaft (with ext. snapping)	6RS; 7RS; 7RA	5406	1
		Snap Ring (on shaft)	6RS; 7RS; 7RA	5407	1
		Retainer, Reverse Gear Worm Gear Drive Shaft Bearing	6RS; 7RS; 7RA	5437	1
		Screw, No. 10-24 x 1/2" Fil. Drilled Hd.	6RS; 7RS; 7RA	5438	3
		Lockwire, 3/64" (std. iron wire 7" long)			*
		Gear, Reverse Gear Drive (49 teeth) (includes bearing)	6RS; 7RS; 7RA	5409	2
		 Bearing, Reverse Gear Drive Gear	6RS; 7RS; 7RA	5410	2
		Thrustwasher, Reverse Gear Drive Gear	6RS; 7RS; 7RA	5412	2
		Washer, Reverse Gear Drive Gear (tanged)	6RS; 7RS; 7RA	5763	2
		Snap Ring	6RS; 7RS; 7RA	5764	2
		Sleeve, Reverse Gear Shifter Clutch (includes drive pins)	6RS; 7RS; 7RA	5413	1
		Pin, Reverse Gear Shifter Clutch Sleeve Drive	6RS; 7RS; 7RA	5414	6
		Washer, Reverse Gear Drive Gear to Transmission	6RS; 7RS; 7RA	5563	*
		Spacer, Reverse Gear Drive Gear to Transmission	6RS; 7RS; 7RA	5564	1
 9.545—REVERSE GEAR SHIFTER FORK AND LEVER					
		Fork, Reverse Gear Shifter Clutch (includes shoes)	6RS; 7RS; 7RA	5417	1
		Key, 5/32" x 5/8" (Woodruff No. 6)	6RS; 7RS; 7RA	229	1
		Bolt 5/16" x 7/8 HEX. HD.	6RS; 7RS; 7RA	103	1
		Lock Washer 5/16"	6RS; 7RS; 7RA	128	1
		Shoe, Reverse Gear Shifter Clutch Fork	6RS; 7RS; 7RA	5418	2
		Shaft, Reverse Gear Shifter Clutch	6RS; 7RS; 7RA	5419	1
		Lever, Reverse Gear Shifter Clutch	6RS; 7RS; 7RA	5420	1
		Key, 5/32" x 5/8" (Woodruff No. 6)	6RS; 7RS; 7RA	175	1
		Bolt, Clamping, 5/16"-18 x 3/4" Hx. Hd.	6RS; 7RS; 7RA	362	1
		Seal, Reverse Gear Shifter Clutch Shaft (felt)	6RS; 7RS; 7RA	5421	1
9.550—STOP ASSEMBLY—REVERSE SHIFTER					
		Stop Assembly, Reverse Shifter	6RS; 7RS; 7RA	5918	1
		Lever Assy., Reverse Stop (includes Bushing)	6RS; 7RS; 7RA	5919	1
		Bushing, Reverse Stop Lever	6RS; 7RS; 7RA	5264	1
		Sleeve, Shifting Lever	6RS; 7RS; 7RA	5920	1
		Cam Lifting-Shifting Pin	6RS; 7RS; 7RA	5921	1
		Shaft, Cam Lifting Lever	6RS; 7RS; 7RA	5922	1
		Block, Shifting Lever	6RS; 7RS; 7RA	5923	1
		Cam, Shifting Lever	6RS; 7RS; 7RA	5933	1
		Washer, Cam Actuating	6RS; 7RS; 7RA	5930	1
		Spring, Shifting Lever	6RS; 7RS; 7RA	5929	2
		Stud, Sliding Cam	6RS; 7RS; 7RA	5932	1
		Washer, Cam Stop	6RS; 7RS; 7RA	5925	1
		Nut, Elastic Stop—3/8"—16NC3	6RS; 7RS; 7RA	5538	1
		Spring, Detent	6RS; 7RS; 7RA	5926	1
		Spacer, Plate Selector	6RS; 7RS; 7RA	5927	1
		Plate, Reverse Pin Shifting Stop	6wS; 7RS; 7RA	5931	1
		Spring, Shifting Stop Pin	6RS; 7RS; 7RA	5924	1
		Pin Assy.—Rev. Lever Stop	6RS; 7RS; 7RA	5942	1
		Pin, Reverse Lever Stop	6RS; 7RS; 7RA	5928	1
		Pin, Groove Type "E"—1/8" x 7/8"	6RS; 7RS; 7RA	269	1
		Bolt, 1/4"—20NC2 x 1 1/4" Hex Hd.	6RS; 7RS; 7RA	268	2
		Washer, Flat, 1/4"	6RS; 7RS; 7RA	130	3
		Lockwasher 1/4"	6RS; 7RS; 7RA	127	2
		Cotterpin, 3/32" x 3/4"	6RS; 7RS; 7RA	139	1
		Cotterpin, 3/32" x 5/8"	6RS; 7RS; 7RA	138	2
		Cotterpin, 5/32" x 1-3/8"	6RS; 7RS; 7RA	140	2
		Shim, Detent, Spring	6RS; 7RS; 7RA	5073	4
		Ball, Fwd. Rev. Control Rod	7RS; 7RA	5936	1
 9.565—TRANSMISSION SPEED SHIFTER ARM AND LINK					
		Link Assembly, Reverse Control	6RS; 7RS; 7RA	5454	1
		Link, Reverse Gear Shift Control (includes coupling)	6RS; 7RS; 7RA	5455	1
		Link, Reverse Gear Shift Control (threaded)	6RS; 7RS; 7RA	5456	1
		Locknut, 3/8"-24 Hx	6RS; 7RS; 7RA	354	1
		Cotterpin, 3/32" x 3/4"	6RS; 7RS; 7RA	139	1
		Lever and Bushing, Reverse Gear Control (on transmission)	6RS; 7RS; 7RA	5457	1
		Cotterpin, 5/32" x 1-3/8"	6RS; 7RS; 7RA	140	2

* As Required

POWER TILLER OF A HUNDRED USES

Illust.		NAME and DESCRIPTION	Models EI	Part Number	Qty.
Fig.	Item				
9.560—TRANSMISSION SPEED SHIFTER ARM AND LINK					
		Arm, Transmission Speed Shifter.....	6RS; 7RS; 7RA	5447	1
		Key, $\frac{3}{32}$ " x $\frac{5}{8}$ " (Woodruff No. 6).....	6wS; 7RS; 7RA	175	1
		Bolt, $\frac{5}{16}$ "-18 Hx. Hd.....	6RS; 7RS; 7RA	362	1
		Trunnion, Arm Shifter Control.....	6RS; 7RS; 7RA	5221	1
		Flatwasher, $\frac{7}{16}$ ".....	6RS; 7RS; 7RA	177	1
		Cotterpin, $\frac{3}{32}$ " x $\frac{3}{4}$ ".....	6RS; 7RS; 7RA	139	1
		Control Assembly, Speed Shifter.....	6RS; 7RS; 7RA	5443	1
		Link, Shift Control—Upper.....	6RS; 7RS; 7RA	5444	1
		Nut, $\frac{3}{8}$ "-24 Hx.....	6wS; 7RS; 7RA	147	1
		Housing, Shift Control Link.....	6RS; 7RS; 7RA	5388	1
		Seat, Shift Control Link Spring.....	6RS; 7RS; 7RA	5389	1
		Pin, $\frac{1}{8}$ " x $1\frac{1}{16}$ " Sq. End Pl.....	6RS; 7RS; 7RA	245	1
		Spring, Shift Control Link.....	6RS; 7RS; 7RA	5390	2
		Cap, Shift Control Link Housing.....	6RS; 7RS; 7RA	5391	1
		Link, Shift Control—Lower.....	6RS; 7RS; 7RA	5387	1
		Cotterpin, $\frac{3}{32}$ " x $\frac{3}{4}$ ".....	6RS; 7RS; 7RA	139	2
		Bracket, Transmission Speed Shifter Link Selector (includes spring).....	6RS; 7RS; 7RA	5459	1
		Spring, Transmission Speed Shifter Link Selector Bracket.....	6RS; 7RS; 7RA	5448	1
		Bolt, $\frac{1}{4}$ "-20 x $\frac{1}{2}$ " Hx. Hd.....	6RS; 7RS; 7RA	355	1
		Lockwasher, $\frac{1}{4}$ " Med.....	6RS; 7RS; 7RA	127	1
		Nut, $\frac{1}{4}$ "-20 Hx.....	6RS; 7RS; 7RA	356	1
9.575—MAGNETO DRIVE SHAFT AND GEAR					
		Gear, Magneto Drive Shaft (20 teeth).....	6RS; 7RS; 7RA	5422	1
		Snap Ring.....	6wS; 7RS; 7RA	5424	1
		Key, $\frac{1}{8}$ " x $\frac{1}{2}$ " (Woodruff No. 3).....	6RS; 7RS; 7RA	142	1
		Spacer, Magneto Drive Shaft Gear.....	6RS; 7RS; 7RA	5425	1
		Thrustwasher, Magneto Drive Shaft Gear.....	6RS; 7RS; 7RA	5133	1
		Shaft, Magneto Drive.....	6RS; 7RS; 7RA	5423	1
		Snapping.....	6RS; 7RS; 7RA	5424	1
9.580—MISCELLANEOUS PARTS					
		Wire, Spark Plug.....	6RS; 7RS; 7RA	5191	1
		Tube, Air Cleaner.....	6RS; 7RS; 7RA	5095	1
		Tube, Air Cleaner.....	6RS; 7RS; 7RA	5609	1
		Clamp, Throttle Control Wire.....	6RS; 7RS; 7RA	5441	1
		Screw, No. 8-32 x $\frac{1}{2}$ " Fil. Hd. Sl.....	6RS; 7RS; 7RA	163	1
		Lockwasher, No. 8 Int. Tooth.....	6RS; 7RS; 7RA	273	1
		Nut, No. 8-32 Sq.....	6RS; 7RS; 7RA	165	1
10.—TILLER AND DRIVE					
10.000—TILLER DRIVE					
NOTE: Includes items listed in GROUPS 10.005 (except 5275 Gasket) thru 10.030, plus 8.000 (except 5209 Dog) and 8.005.					
		Tiller Drive.....	All	5273	1
		Cap Screw, $\frac{3}{8}$ "-16 x 1" Hx. Hd.....	All	110	4
		Lockwasher, $\frac{3}{8}$ ".....	All	129	4
10.005—TILLER DRIVE HOUSING					
		Housing, Tiller Drive.....	All	5274	1
		Gasket, Tiller Drive Housing.....	All	5275	1
		Cover, Tiller Drive Housing.....	All	5276	1
		Bolt, $\frac{5}{16}$ "-18 x $1\frac{1}{16}$ " Hx. Hd.....	All	104	4
		Lockwasher, $\frac{5}{16}$ ".....	All	128	4
		Gasket, Tiller Drive Housing Cover.....	All	5277	1
10.020—TILLER DRIVE GEAR					
		Gear, Tiller Bevel Drive.....	All	5278	1
		Key, $\frac{3}{16}$ " x $\frac{3}{16}$ " x $1\frac{3}{4}$ ".....	All	5279	1
		Set Screw $\frac{5}{16}$ "-24 x $\frac{5}{8}$ " Hex. Socket Cup Point.....	All	352	1
		Lock Nut $\frac{5}{16}$ "-24 Hex.....	All	353	1
		Shim, Tiller Drive Gear (.005).....	All	5280	*
		Pinion, Tiller Drive.....	All	5281	1
		Bearing, Tiller Drive Pinion—Front (needle type).....	6; 6RS	5282	1
		Bearing, Tiller Drive Pinion—Rear (ball).....	All	5283	1
		Bearing, Tiller Drive Pinion—Front (bronze bushing).....	7; 7RS; 7A; 7RA	5499	1
		Sleeve, Tiller Drive Pinion Needle Bearing.....	All	5665	1
10.030—TILLER DRIVE SHAFT					
		Shaft, Tiller Drive.....	All	5284	1
		Bearing Cone, Tiller Drive Shaft.....	All	5285	2
		Bearing Cup, Tiller Drive Shaft.....	All	5286	2
		Snap Ring (gear end).....	All	5287	1
		Snap Ring (beveled).....	All	5288	1
		Oil Seal, Tiller Drive Shaft.....	All	5289	2

* As Required

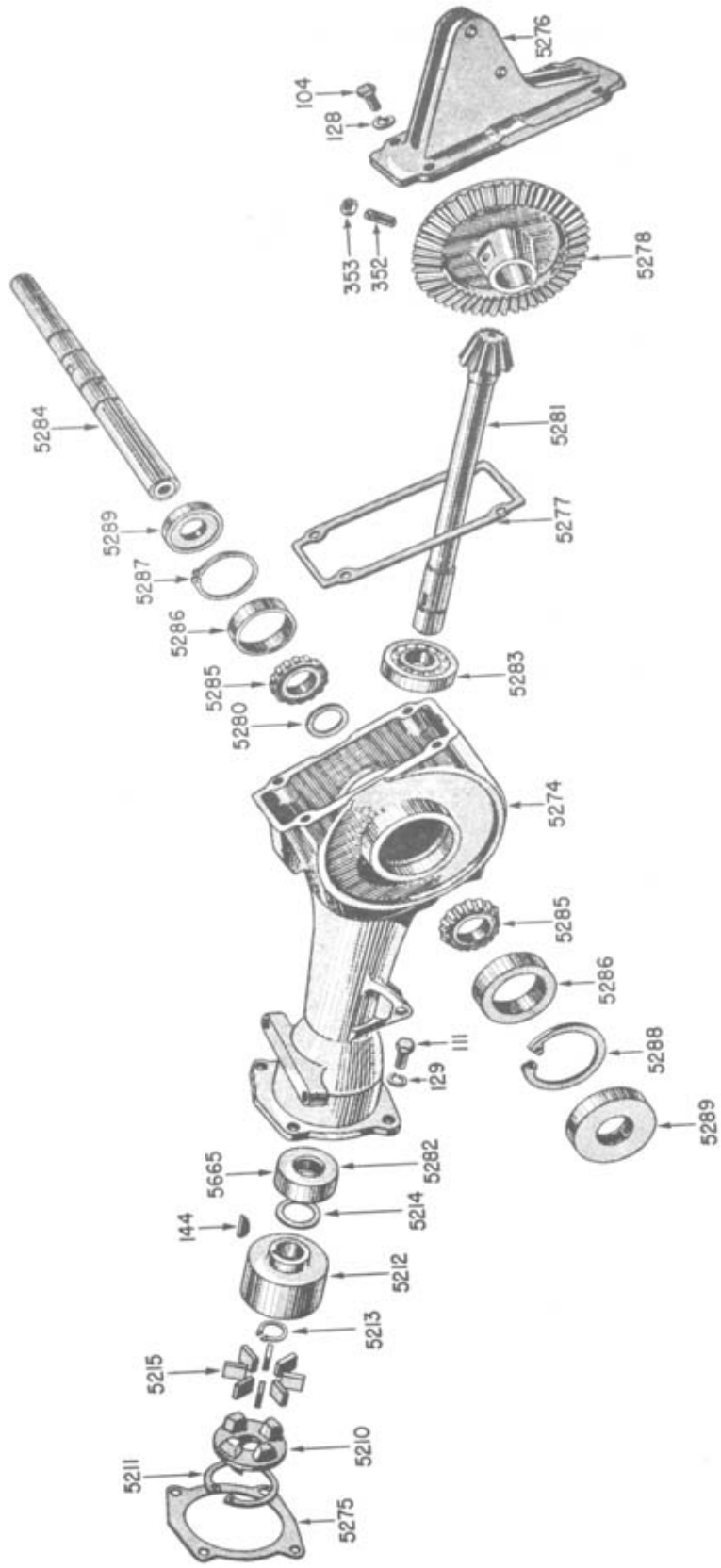

EXPLODED TILLER DRIVE ASSEMBLY

ROTOTILLER POWER TILLER

Illust.		NAME and DESCRIPTION	Models B1	Part Number	Qty.
Fig.	Item				
10.060—TILLER DEPTH RUNNER					
		Runner, Tiller Depth.....	All	5290	1
		Bolt, $\frac{3}{8}$ "-16 x $1\frac{1}{2}$ " Hx. Hd. (front).....	All	172	1
		Lockwasher, $\frac{3}{8}$ ".....	All	129	2
		Nut, $\frac{3}{8}$ "-16 Hx. (front bolt).....	All	173	1
		Clevis Pin, $\frac{5}{16}$ " x $1\frac{7}{8}$ ".....	All	5396	1
		Cotter Pin, $\frac{3}{32}$ " x $\frac{3}{4}$ ".....	All	139	1
		Flat Washer, $\frac{5}{16}$ ".....	All	225	1
10.060—TILLER TINE SPRING HOLDER					
		Holder, Tine Spring (20" tiller).....	All	5292	2
		Holder, Tine Spring (26" tiller).....	All	5293	2
		Key, $\frac{3}{16}$ " x $\frac{3}{16}$ " x $2\frac{3}{4}$ ".....	All	5294	2
		Stud, for 20" Tiller, $\frac{3}{8}$ "-24 x $\frac{3}{8}$ "-24 x $6\frac{3}{8}$ ".....	All	5295	2
		Stud, for 26" Tiller, $\frac{3}{8}$ "-24 x $\frac{3}{8}$ "-24 x $8\frac{1}{2}$ ".....	All	5296	2
		Flatwasher, $1\frac{3}{32}$ " x $1\frac{3}{8}$ " x $\frac{3}{8}$ ".....	All	5297	2
		Nut, $\frac{3}{8}$ "-24 Hx. (elastic stop).....	All	5298	2
		Thrust Washer, Tine Spring Holder.....	All	5261	2
10.070—TILLER TINE HOLDER SPRING					
NOTE: 10 Tiller Tine Springs are used on 20" Tillers, whereas 12 are used on 26" Tillers. Orders for these parts must be placed accordingly.					
		Spring, Tine Holder (chrome vanadium).....	All	5299	*
		Cotterpin, $\frac{1}{8}$ " x $\frac{3}{4}$ " (2 per spring).....	All	238	*
10.075—TILLER TINES					
NOTE: 5 R.H. and 5 L.H. Tines are used on 20" Tillers, whereas 6 R.H. and 6 L.H. Tines are used on 26" Tillers, except the pointed Tines which are all the same, 10 being used on the 20" Tiller and 12 on the 26" Tiller. Specify type of Tines when ordering.					
		Tine, Pointed.....	All	5300	*
		Tine, Paring, R.H.....	All	5301	*
		Tine, Paring, L.H.....	All	5302	*
		Tine, "S", R.H.....	All	5303	*
		Tine, "S", L.H.....	All	5304	*
		Tine, Knife, R.H.....	All	5305	*
		Tine, Knife, L.H.....	All	5306	*
14.—STEERING					
14.000—HANDLE BAR BASE AND SECTOR					
		Base and Sector Assembly, Handle Bar.....	All	5307	1
		Bolt, $\frac{3}{8}$ "-16 x $1\frac{3}{8}$ " Hx. Hd.....	All	113	4
		Lockwasher, $\frac{3}{8}$ ".....	All	129	4
14.005—HANDLE BAR BASE					
		Base, Handle Bar (includes horizontal sector).....	All	5308	1
		Sector, Handle Bar Vertical (includes pivot stud and horizontal lock-pin).....	All	5309	1
		Stud, 1"-8 x 1"-14 x $4\frac{1}{16}$ ".....	All	5310	1
		Tape: Pin, Stud Lock, No. 2 x $1\frac{1}{2}$ ".....	All	158	1
		Flatwasher, 1" x 2" x $\frac{1}{8}$ ".....	All	136	1
		Nut, 1"-14 Sl. Hx.....	All	151	1
		Cotterpin, $\frac{1}{8}$ " x $1\frac{3}{4}$ ".....	All	496	1
* As Required					

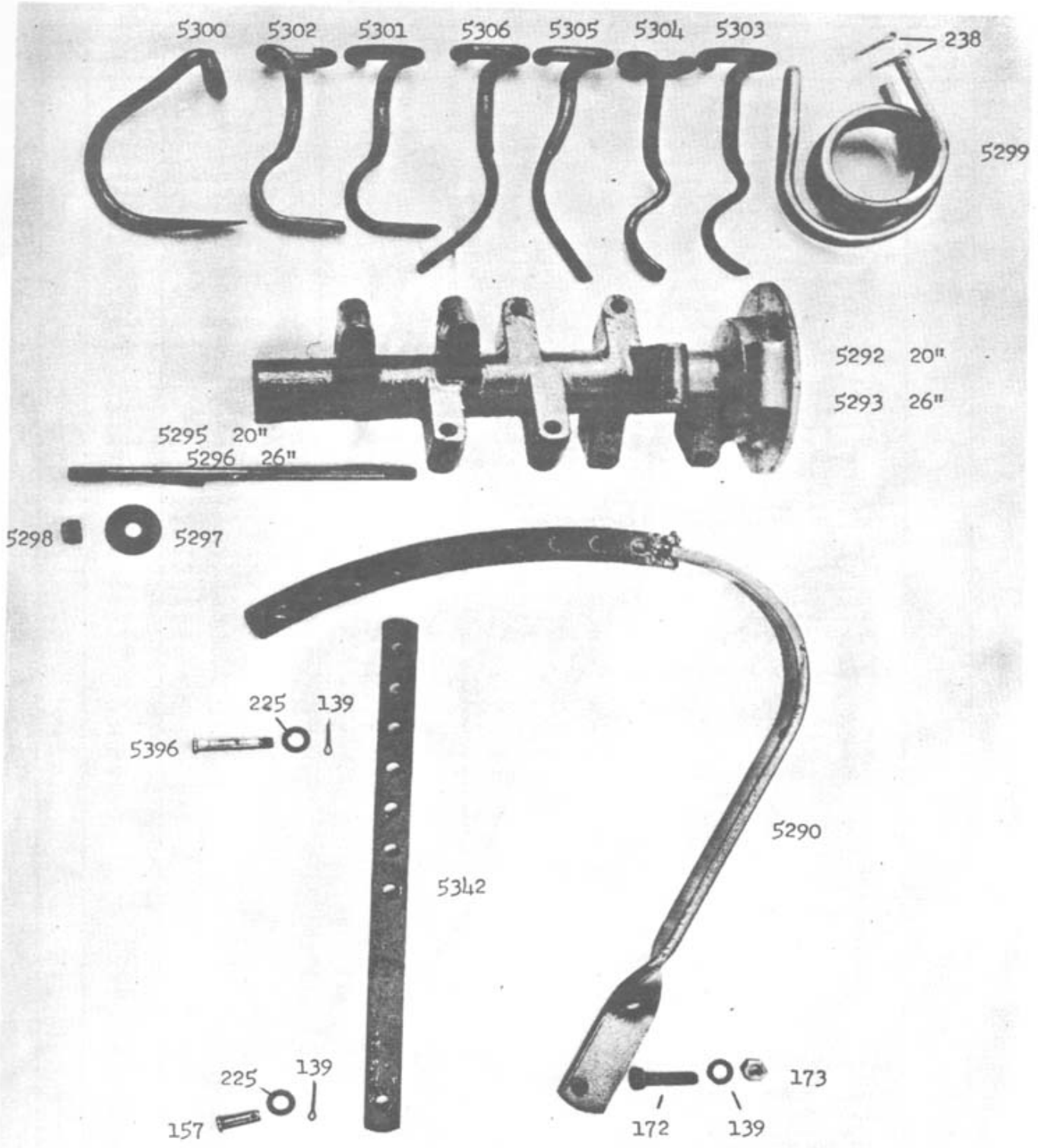

ACCESSORIES FOR TILLER DRIVE ASSEMBLY

POWER TILLER OF A HUNDRED USES

Illust.		NAME and DESCRIPTION	Models B1	Part Number	Qty.
Fig.	Item				
14.020—HANDLE BAR					
		Handle Bar Assv. Complete.....	6; 6RS	5910	1
		Handle Bar (Frame).....	6; 6RS	5311	1
		Handle Bar Assy. Complete.....	7; 7RS	5621	1
		Handle Bar (Frame).....	7; 7RS; 7A; 7RA	5608	1
		Handle Bar Assy. Complete.....	7A; 7RA	5940	1
		Bolt, $\frac{5}{8}$ "-11 x 3" Hx. Hd.....	6; 6RS	5312	1
		Bolt, $\frac{5}{8}$ "-11 x $3\frac{1}{4}$ " Hx. Hd.....	7; 7RS; 7A; 7RA	5622	1
		Nut, $\frac{5}{8}$ "-11 Hx.....	All	149	1
		Cotterpin, $\frac{5}{32}$ " x $1\frac{3}{8}$ ".....	All	140	1
		Grip, Handle Bar.....	6; 6RS	5313	2
		Grip, Handle Bar.....	7; 7RS; 7A; 7RA	5617	2
		Screw, Wood No. 8 x $\frac{5}{8}$ " Fl. Hd.....	6; 6RS	123	2
		Sleeve, Handle Bar Grip.....	6; 6RS	5314	2
14.030—HANDLE BAR HORIZONTAL CONTROL					
		Pin, Handle Bar Horizontal Lock.....	All	5315	1
		Pin, Pivot, $1\frac{1}{16}$ " Long.....	All	5316	1
		Spring, Handle Bar Horizontal Lock Pin.....	All	5317	2
		Spring, Handle Bar Horizontal Lock Pin Auxiliary.....	All	5318	1
		Screw, No. 10-24 x $\frac{3}{8}$ " Rd. Hd.....	All	119	2
		Lockwasher, No. 10.....	All	126	2
		Rod, Handle Bar Horizontal Control (includes grip).....	6; 6RS	5319	1
		Rod, Handle Bar Adjustment Control—Upper.....	7; 7RS; 7A; 7RA	5611	1
		Rod, Handle Bar Adjustment Control—Lower.....	7; 7RS; 7A; 7RA	5612	1
		Ball Knob, Handle Bar Adjustment Control Rod.....	7; 7RS; 7A; 7RA	5614	1
		Link, Upper to Lower Control Rod.....	7; 7RS; 7A; 7RA	5618	1
		Cotterpin, $1/16$ " x $1\frac{1}{2}$ ".....	7; 7RS; 7A; 7RA	137	4
		Pin, Control Rod Link.....	7; 7RS; 7A; 7RA	5912	1
		Stud, Hand Bar Adjustment Key.....	7; 7RS; 7A; 7RA	5799	1
		Key, Handle Bar Adjustment.....	7; 7RS; 7A; 7RA	5619	1
		Spring, Handle Bar Adjustment Key Retaining.....	7; 7RS; 7A; 7RA	5602	1
14.040—HANDLE BAR VERTICAL CONTROL					
		Pin, Handle Bar Vertical Lock.....	6; 6RS	5320	1
		Flatwasher, $1\frac{1}{32}$ " x 1" x $\frac{3}{32}$ ".....	6; 6RS	5321	1
		Spring, Coil.....	6; 6RS	5322	1
		Rod, Handle Bar Vertical Control (includes knob).....	6; 6RS	5323	1
		Cotterpin, $\frac{3}{32}$ " x $\frac{3}{4}$ ".....	6; 6RS	139	1
16.—WHEELS					
16.000—WHEELS					
		Wheel (disc.) (used with 4.00 x 12 tire and tube).....	All	5324	2
		Wheel, Cleated, Right.....	All	5325	1
		Wheel, Cleated, Left.....	All	5326	1
		Bolt, Wheel Hub.....	All	5327	10
16.010—WHEEL HUB (OUTER)					
		Hub, Wheel Outer (on units with free wheeling).....	6; 6RS	5328	2
		Hub, Wheel (units without free wheeling).....	6; 6RS	5460	2
		Key, $\frac{3}{16}$ " x $\frac{3}{16}$ " x $2\frac{1}{8}$ " (units without free wheeling).....	6; 6RS	5329	2
		Oil Seal, Wheel Hub. O.D. $1\frac{3}{16}$ " (units without free wheeling).....	6; 6RS	5461	2
		Washer Oil Seal, Wheel Hub.....	All	5767	2
		Flatwasher, $\frac{3}{4}$ " Lg.....	6; 6RS	135	2
		Nut, $\frac{3}{4}$ "-16 Hx. Sl.....	6; 6RS	5790	2
		Cotterpin, $\frac{3}{32}$ " x 2".....	6; 6RS	141	2

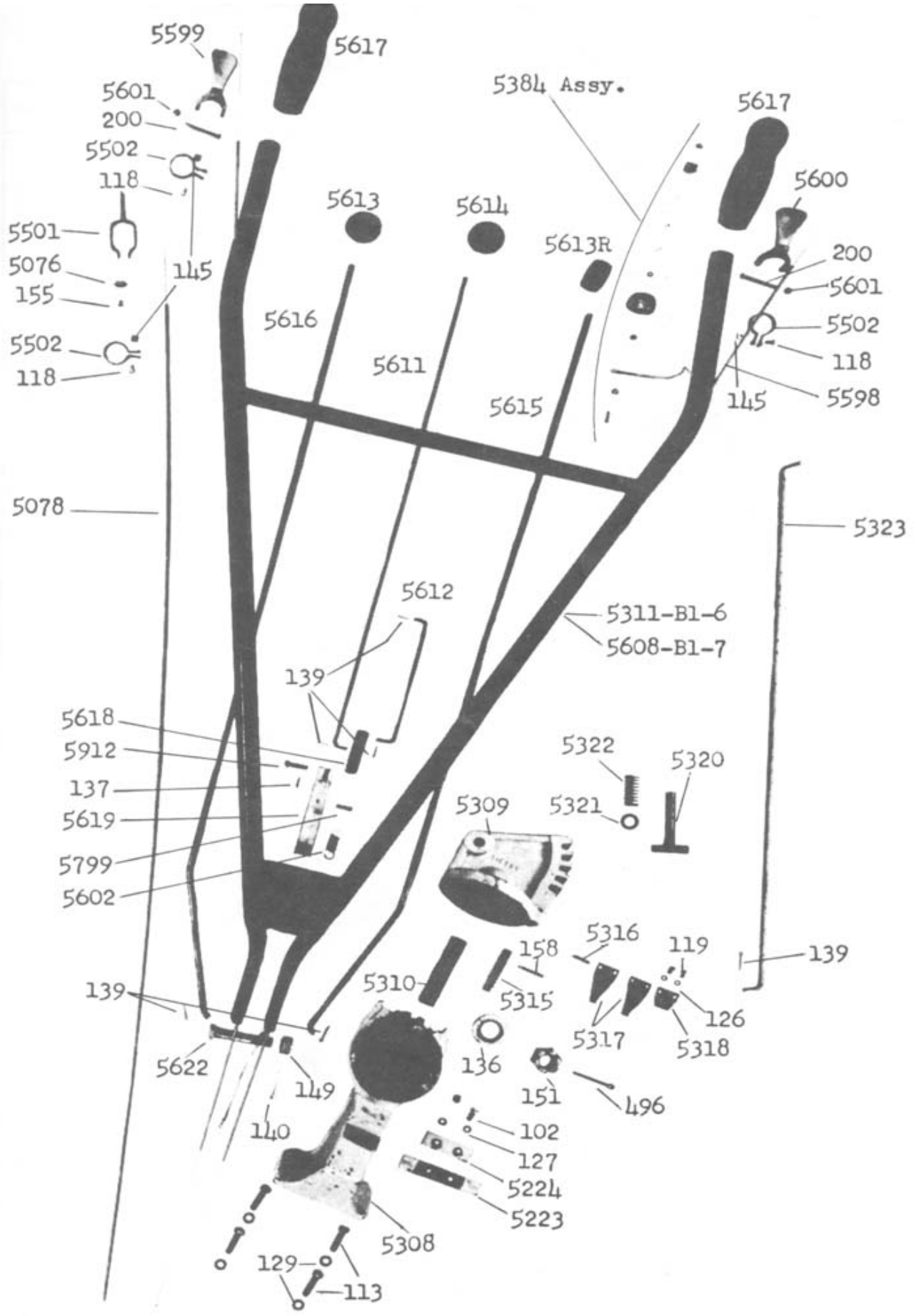

ROTOTILLER POWER TILLER

Illust.		NAME and DESCRIPTION	Models B1	Part Number	Qty.
Fig.	Item				
		16.200—HUB CLUTCH KIT			
		Kit, Wheel Hub Clutch Installation		5565	1
		NOTE: Includes all parts necessary to install Hub Clutch on B1-6 and B1-6RS models.			
		16.210—WHEEL HUB			
		Hub, Spring Clutch Wheel	7; 7RS	5566	2
		Flat Washer, 3/4" Large	7; 7RS	135	2
		Nut, 3/4"-16 Hex. SL	7; 7RS	5790	2
		Cotterpin, 5/32" x 2"	7; 7RS	141	2
		Spring, Hub Clutch R.H.	7; 7RS	5567	1
		Spring, Hub Clutch L.H.	7; 7RS	5568	1
		Pin, Spring Clutch Wheel Hub	7; 7RS	5569	2
		16.215—WHEEL HUB BEARING			
		Lock Out Bushing Kit (All Rototillers w/Hub Clutches)	7; 7RS	5663	1
		Bushing Assy, Wheel Hub (includes next 6 items)	7; 7RS	5657	2
		Bushing	7; 7RS	5658	2
		Key, Bushing	7; 7RS	5662	2
		Pin, Hub Locking	7; 7RS	5766	2
		Spring, Locking Pin Retaining	7; 7RS	5659	2
		Screw, Retaining Spring	7; 7RS	213	2
		Washer, Retaining Spring	7; 7RS	273	2
		16.220—HUB CLUTCH SEALS			
		Seal, Oil and Dust—Outer	7; 7RS	5571	2
		Retainer, Outer Seal	7; 7RS	5572	2
		Seal, Oil and Dust—Inner	7; 7RS	5577	2
		Retainer, Inner Seal	7; 7RS	5576	2
		Seal, Oil and Dust—Transmission Side	7; 7RS	5584	2
		Seal, Oil—Transmission Side	All	5767	2
		Washer, Thrust—Outer	7; 7RS	5578	2
		16.225—WHEEL CONTROL CLUTCH RACE			
		Race Assembly, Wheel Control Clutch—Outer	7; 7RS	5574	2
		Spacer, Outer Race	7; 7RS	5575	2
		Key, Outer Race—No. 15 (3/4" x 1")	7; 7RS	191	2
		Race, Wheel Control Clutch—Inner	7; 7RS	5592	2
		Key, Inner Race	7; 7RS	5573	2
		16.230—CLUTCH CONTROL SHOE AND SHAFT			
		Shoe, Clutch Control	7; 7RS	5579	2
		Shaft, Clutch Control	7; 7RS	5580	2
		16.235—HUB CONTROL PLUG AND LEVER			
		Plug Assembly, Hub Control	7; 7RS	5582	2
		Lever Assembly, Hub Control	7; 7RS	5581	2
		Screw, Hub Control Lever to Plug	7; 7RS	118	2
		Lock Washer, Hub Control Lever to Plug	7; 7RS	193	2
		* As Required			

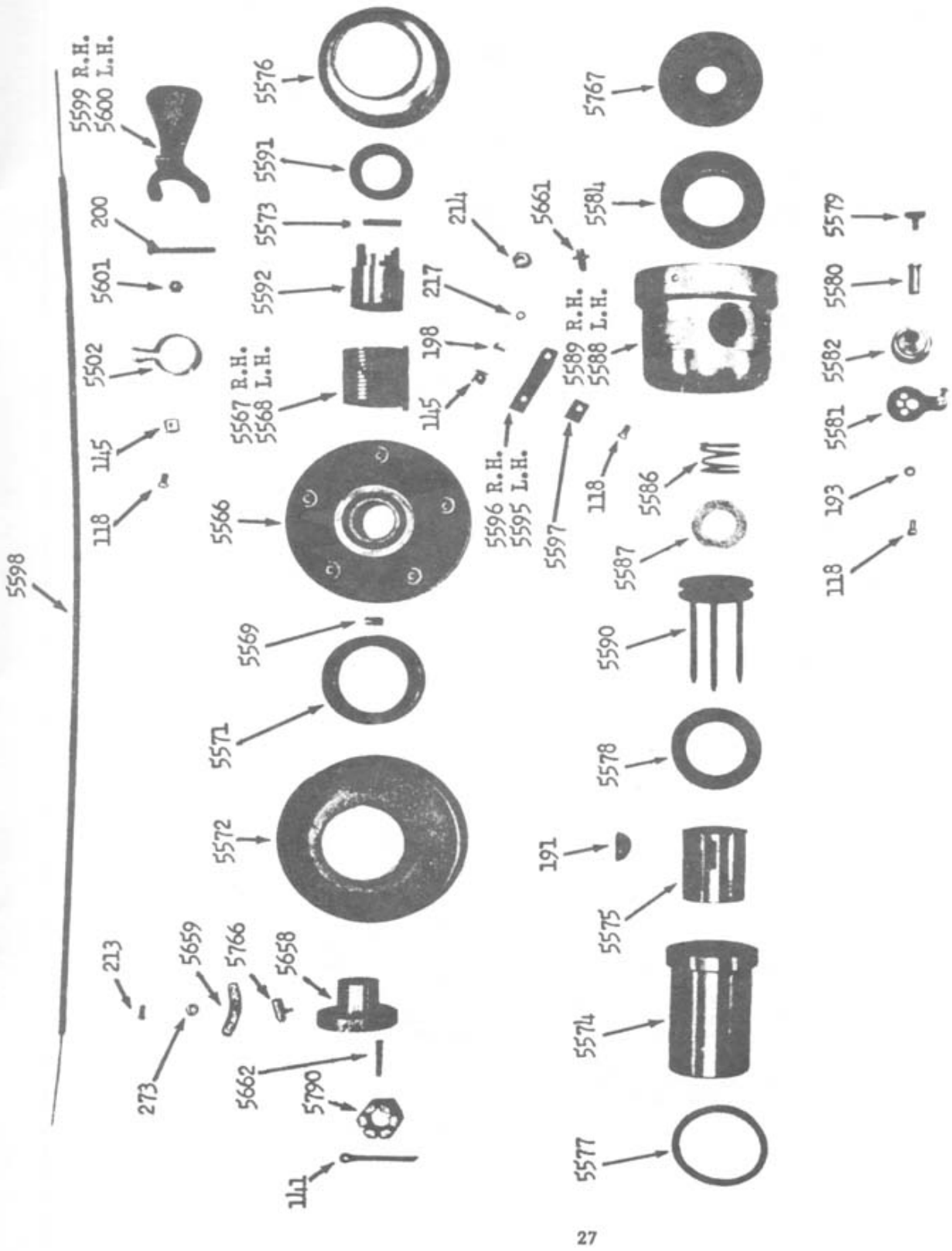

EXPLODED VIEW OF HUB CLUTCH KIT
PART#5565

POWER TILLER OF A HUNDRED USES

Illust.		NAME and DESCRIPTION	Models B1	Part Number	Qty.
Fig.	Item				
16.240—HUB					
		Hub, Inner—R.H.	7: 7RS	5589	1
		Hub, Inner—L.H.	7: 7RS	5588	1
		Stud, Hub to Frame	7: 7RS	5661	2
		Nut, Stud Locking	7: 7RS	214	2
16.245—ENERGIZER					
		Energizer Assembly	7: 7RS	5590	2
		Ring, Energizer	7: 7RS	5591	2
		Washer, Friction Arresting	7: 7RS	5587	2
16.250—CLUTCH ACTUATING SPRING					
		Spring, Clutch Actuating	7: 7RS	5586	2
16.255—CLUTCH CONTROL HANDLES					
		Handle, Hub Clutch Control R.H.	7: 7RS	5599	1
		Handle, Hub Clutch Control L.H.	7: 7RS	5600	1
		Nut, Hub Clutch Control Handle Stop	7: 7RS	5601	2
		Screw, Cable to Control Lever	7: 7RS	192	2
		Screw, Control Handle	7: 7RS	200	2
16.260—CONTROL CABLES AND CLAMPS					
		Cable Assembly, Wheel Control Clutch	7: 7RS	5598	2
		Clip, Control Cable—on Handle Bar	7: 7RS	5502	2
		Screw, Control Cable Clip—on Handle Bar	7: 7RS	118	3
		Nut, Control Cable Clip—on Handle Bar	7: 7RS	145	3
		Clamp, Control Cable—on Hub	7: 7RS	5597	2
		Clip, Control Cable—on Hub—R.H.	7: 7RS	5596	1
		Clip, Control Cable—on Hub—L.H.	7: 7RS	5595	1
		Screw, Control Cable Clip—on Hub	7: 7RS	198	6
		Nut, Control Cable Clip—on Hub	7: 7RS	145	2
		Washer, Control Cable Clip and Control Lever	7: 7RS	217	8
WHEEL HUB INNER—See Group 9.085					
16.270—HUB ASSEMBLY-WHEEL-DIRECT DRIVE					
		Hub Assembly, Wheel Direct Drive	7A: 7RA	5934	2
		Hub and Insert Assy.—Outer	7A: 7RA	5913	2
		Key, Hub to Shaft— $3/16" \times 3/16" \times 2-3/8"$	7A: 7RA	5329	2
		Flatwasher, Hub Retaining— $3/4"$ large	7A: 7RA	135	2
		Nut, Hub Retaining— $3/4"-16$ Hex Slotted	7A: 7RA	5790	2
18.—SHEET METAL					
18.000—TILLER HOOD ASSEMBLY					
NOTE: Includes items listed in Groups 18.000 (except 5353 Plug) and 18.090.					
		Hood Assembly—20" Tiller (includes flaps)	All	5330	1
		Hood Assembly—26" Tiller (includes flaps)	All	5331	1
		Pin, Hood Housing Bracket $3/8" \times 9 \times 3/2"$	All	5332	1
		Flatwasher, $3/8"$	All	131	2
		Cotterpin, $3/32" \times 3/4"$	All	139	2
		Bracket, Tiller Hood Mounting	All	5333	1
		Lockwasher, $3/8"$	All	129	2
		Nut, $3/8"-16$ Hx	All	146	2
		Bolt, $3/8"-16 \times 1-3/8"$ Hex. Hd.	All	133	2

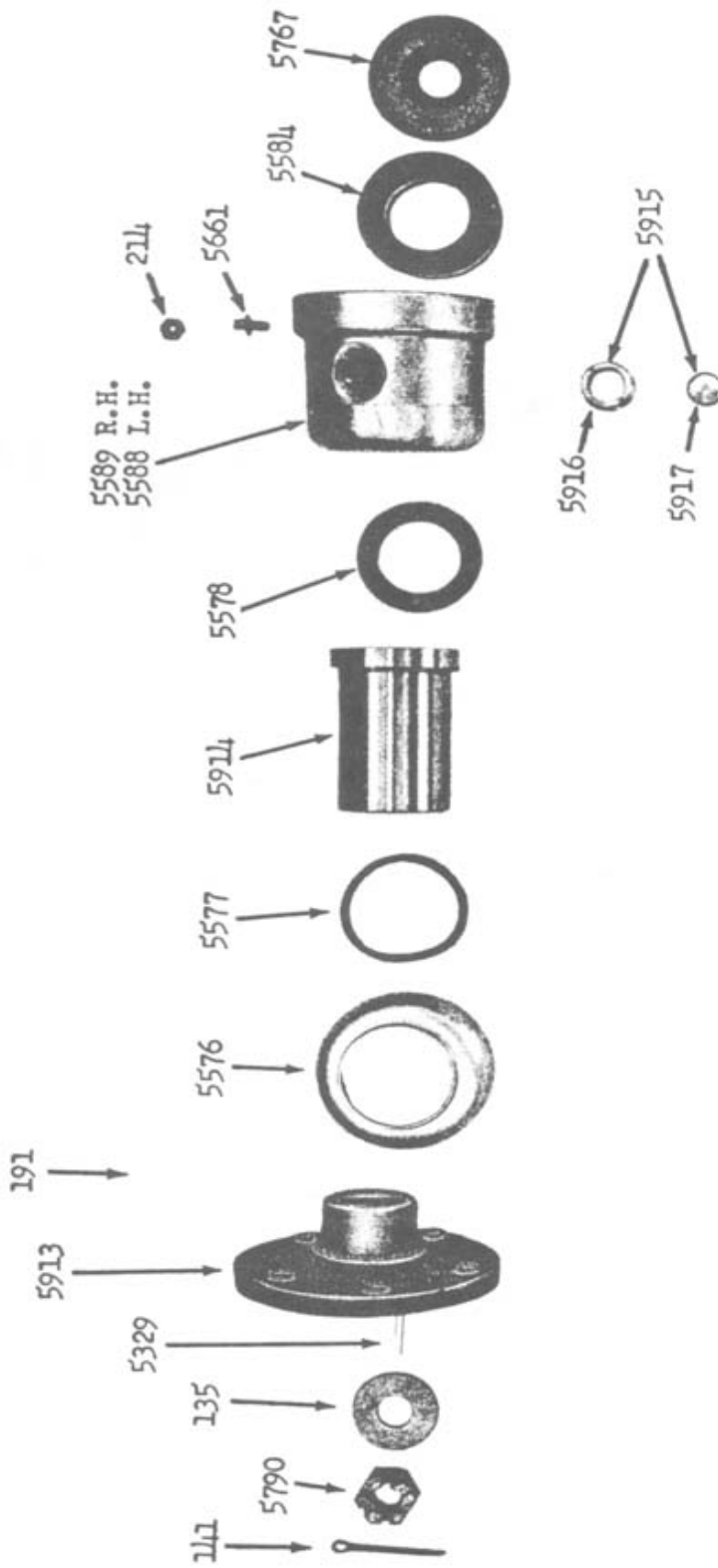

EXPLODED VIEW OF DIRECT HUB ASSEMBLY
 PART #5934

R.H. HUB ASSEMBLY COMPLETE #5935
 L.H. HUB ASSEMBLY COMPLETE #5936

ROTOTILLER POWER TILLER

Illust.		NAME and DESCRIPTION	Models B1	Part Number	Qty.
Fig.	Item				
18.010—TILLER HOOD					
		Hood—20" Tiller (less flaps)	All	5334	1
		Hood—26" Tiller (less flaps)	All	5335	1
		Flap, Upper, Tiller Hood—20"	All	5336	1
		Flap, Upper, Tiller Hood—26"	All	5337	1
		Flap, Lower, Tiller Hood—20"	All	5338	1
		Flap, Lower, Tiller Hood—26"	All	5339	1
		Pin, Tiller Flap Hinge	All	5340	4
		Cotterpin, $\frac{1}{16}$ " x $\frac{1}{2}$ "	All	137	4
18.020—TILLER HOOD ADJUSTING BAR					
		Bar, Tiller Hood Adjusting	All	5342	1
		Clevis Pin, $\frac{5}{16}$ " x $3\frac{1}{32}$ "	All	157	1
		Clevis Pin, $5/16$ " x $1-7/8$ "	All	5396	1
		Flatwasher, $5/16$ "	All	225	1
		Cotterpin, $3/32$ " x $3/4$ "	All	139	1
		Lockwasher, $\frac{5}{16}$ "	All	128	1
		Cotterpin, $3/32$ " x $3/4$ "	All	139	1
20.—TOOLS AND MISCELLANEOUS					
20.500—TOOLS					
		Tool Kit (includes items listed below)	All	5343	1
		Hammer	All	5344	1
		Pliers	All	5345	1
		Screwdriver	All	5346	1
		Grease Gun	All	5347	1
		Wrench, Wheel and Magneto	All	5348	1
		Wrench, Spark Plug	All	5349	1
		Wrench, Open End ($3/4$ " x $9/16$ ")	All	5350	1
20.600—PAINT					
		Enamel—Yellow—(Air Dry) (quart or gallon cans)	All	5620	*
		Enamel—Blue—(Air Dry) (pint cans only)	All	5625	*
* As Required					

STANDARD PARTS

50.000			
BOLT—HEXAGON HEAD		NUT—HEXAGON	
$\frac{1}{4}$ "-20 x $\frac{1}{2}$ " 101 $\frac{1}{4}$ "-20 x $\frac{5}{8}$ " 102 $\frac{1}{4}$ "-28 x $\frac{7}{16}$ " 202 $\frac{5}{16}$ "-18 x $\frac{7}{8}$ " 103 $\frac{5}{16}$ "-18 x $1\frac{1}{16}$ " 104 $\frac{5}{16}$ "-18 x $\frac{3}{4}$ " 362 $\frac{5}{16}$ "-18 x $1\frac{3}{8}$ " 105 $\frac{3}{8}$ "-16 x $\frac{1}{2}$ " 107 $\frac{3}{8}$ "-16 x $\frac{3}{4}$ " 109 $\frac{3}{8}$ "-16 x $\frac{7}{8}$ " 110 $\frac{3}{8}$ "-16 x 1" steel 566 $\frac{3}{8}$ "-16 x 1" brass 112 $\frac{3}{8}$ "-16 x $1\frac{1}{2}$ " 172 $\frac{3}{8}$ "-16 x $1\frac{3}{4}$ " 113 $\frac{3}{8}$ "-16 x $2\frac{3}{4}$ " 114 $\frac{1}{2}$ "-13 x 1" 115	No. 6-32 228 $\frac{3}{8}$ "-16 light 146 $\frac{3}{8}$ "-16 173 $\frac{3}{8}$ "-24 147 $\frac{3}{8}$ "-24 Cad. 188 $\frac{5}{16}$ "-24 brass 148 $\frac{5}{8}$ "-11 149 $\frac{1}{4}$ "-20 356 $\frac{1}{4}$ "-20 Jam 214 $\frac{3}{4}$ "-16 slotted 150 1"-14 slotted 151		
BOLT—ROUND HEAD SLOTTED		NUT—SQUARE	
$\frac{5}{16}$ "-18 x $\frac{1}{2}$ " 116 $\frac{5}{16}$ "-18 x $\frac{3}{4}$ " 117	No. 8-32 165 No. 10-32 145		
CLEVIS PIN		NUT—FLARED TUBE	
$\frac{5}{16}$ " x $1\frac{1}{32}$ " 157	$\frac{1}{4}$ " x $\frac{7}{16}$ "-20 152		
COTTERPIN		PIPE PLUG—SQUARE HEAD	
$\frac{1}{16}$ " x $\frac{1}{2}$ " 137 $\frac{3}{32}$ " x $\frac{3}{4}$ " 139 $\frac{1}{8}$ " x $\frac{3}{4}$ " 238 $\frac{5}{32}$ " x $1\frac{3}{8}$ " 140 $\frac{3}{32}$ " x 2" 141	$\frac{1}{4}$ " 120 $\frac{3}{8}$ " 121		
ELBOW—FLARED TUBE		SCREW—FILLISTER HEAD	
$\frac{1}{4}$ " ($\frac{7}{16}$ "-20) 154	No. 8-32 x $\frac{1}{4}$ " 155 No. 8-32 x $\frac{1}{2}$ " 163 No. 10-32 x $\frac{3}{8}$ " 118		
FLATWASHER		SCREW—ROUND HEAD	
$\frac{1}{4}$ " 130 $\frac{3}{8}$ " 131 $\frac{7}{16}$ " 177 $\frac{5}{8}$ " 133 $\frac{3}{4}$ " small 134 $\frac{3}{4}$ " large 135 $1\frac{1}{16}$ " 136	No. 6-23 x $\frac{1}{4}$ " 237 No. 6-32 x $\frac{5}{8}$ " 204 No. 10-24 x $\frac{3}{8}$ " 119 No. 10-32 x $\frac{3}{8}$ " 194		
GREASE FITTING		SCREW—FLAT HEAD—WOOD	
$\frac{1}{8}$ " pipe 5486	No. 8- $\frac{5}{8}$ " 123		
KEY—WOODRUFF		STRAIGHT PIN	
No. 3 ($\frac{1}{8}$ " x $\frac{1}{2}$ ") 142 No. 6 ($\frac{5}{32}$ " x $\frac{5}{8}$ ") 175 No. 6 ($\frac{5}{32}$ " x $\frac{5}{8}$ ") 229 No. 9 ($\frac{3}{16}$ " x $\frac{3}{4}$ ") 143 No. A ($\frac{1}{4}$ " x $\frac{7}{8}$ ") 144 No. 15 ($\frac{1}{4}$ " x 1") 191	$\frac{1}{8}$ " x $1\frac{1}{16}$ " 245		
LOCKWASHER		TAPER PIN	
No. 10 126 $\frac{1}{4}$ " 127 $\frac{7}{16}$ " 193 $\frac{5}{16}$ " 128 $\frac{3}{8}$ " 129	No. 2 x $1\frac{1}{2}$ " 158		
		SCREW—ROUND HEAD SLOTTED—TAPPING	
		No. 6 x $\frac{3}{8}$ " 169 No. 6 x $\frac{1}{4}$ " 237	
		DOWEL PIN	
		$\frac{1}{8}$ " x $\frac{5}{16}$ " 176	
		SET SCREW	
		$\frac{5}{16}$ "-18 x $\frac{5}{8}$ " 595 $\frac{5}{16}$ "-18 x 1" 332 $\frac{1}{4}$ "-20 x $\frac{3}{4}$ " 596 $\frac{1}{4}$ "-20 x 1" 174	
		CLAMP—HOSE	
		$1\frac{1}{16}$ " 201	